



STAFF REPORT

City Council

Meeting Date:

3/14/2023

Staff Report Number:

23-067-CC

Regular Business:

Appropriate funds related to and supporting the Menlo Park Community Campus project

Recommendation

Staff recommends that the City Council appropriate \$2.225 million in recreation in-lieu fee funds towards the Menlo Park Community Campus (MPCC) project. These funds are required to support the City-requested enhancements to the MPCC project, the City's costs for furniture and non-fixed equipment in the new facility, and costs to extend the duration of interim services during the new facility's construction.

Policy Issues

City Council sets policy and goals and provides direction to staff regarding municipal projects and services to the Menlo Park community; authorizes budget appropriations to support City services and programs; and authorizes the city manager to negotiate and execute agreements and procure resources. City Council established the MPCC project as one of the City's top priorities.

Background

On December 16, 2019, Facebook (now Meta) submitted its proposal for exploring the funding and development of a new multigenerational center to incorporate the former Onetta Harris Community Center, Menlo Park Senior Center, Belle Haven Youth Center (school age child care), Belle Haven Pool and Belle Haven Branch Library.

On January 12, 2021, City Council approved the architectural control, use permit, funding and improvements agreement for the MPCC project located at 100-110 Terminal Avenue. City Council requested further review of several design elements of the proposed pool area. Those items were discussed January 26, 2021, and February 1, 2021. City Council approved the pool design elements February 1, 2021.

City Council created the MPCC subcommittee to work with City staff and the community on the MPCC project. The MPCC Subcommittee is currently comprised of Vice Mayor Taylor and City Councilmember Nash. The MPCC subcommittee convened a working group of Menlo Park residents to support and advise the subcommittee's work.

A project webpage was created (Attachment A) to make project information readily accessible to the public, including the option to subscribe (Attachment B) to receive project updates and announcements by email or text message.

In summer 2021, four City facilities located at 100-110 Terminal Avenue (Onetta Harris Community Center, Menlo Park Senior Center, Belle Haven Youth Center, and Belle Haven Pool) were demolished to make way for the MPCC project construction. The programs formerly housed in those facilities were moved to

interim service locations during construction, and will move into the new MPCC facility when it is completed, along with the Belle Haven Branch Library which is currently located at 413 Ivy Drive on the Belle Haven Elementary School campus.

Construction of the MPCC project began in November 2021 and is anticipated to be completed by early 2024. As summarized in the January 24 update to the City Council, the completion date has moved several months due to supply chain issues for critical electrical infrastructure equipment. Unprecedented supply chain issues are prevalent throughout the construction industry, and continue to impact the timely availability of critically important infrastructure, equipment and materials. The electrical infrastructure equipment is a critical path component that must be implemented before subsequent construction phases can be completed. The project team is currently evaluating the cost and schedule efficiencies either to temporarily demobilize construction activity to save costs while awaiting the necessary infrastructure equipment; or to continue working with a potentially reduced presence on-site. These two options are further described below in the Analysis section.

If temporary demobilization is found to be more efficient, it would be tentatively planned to begin in May 2023, with construction resuming in August 2023. During the temporary demobilization period, the project site will be temporarily closed and secured, and no major construction activity will occur. The construction fencing will be reconfigured to maximize public access to the parking areas to the greatest extent possible.

City staff and the project team will continue, in parallel, to focus on other project-related activities during this period, including preparations for staffing and operating the new facility, developing policies and partnerships to support its programs and services, and developing plans for renovating the athletic field at Kelly Park, among other preparatory work.

Analysis

As described in the informational update provided to the City Council January 24, a budget amendment is needed to provide the necessary funding for several components of the MPCC project. The following sections summarize these items in two categories, new requests and project cost escalations, followed by an overall summary.

New requests

1. Furniture and non-fixed equipment. A new one-time budget appropriation is needed to allocate funding for the procurement of the new facility's furniture, fitness equipment, library book sorter and other non-fixed equipment and assorted equipment items. City Council reviewed the proposed MPCC furniture layouts September 13, 2022 (Attachment C.) Authorization is needed to appropriate the funding for the furnishings and non-fixed equipment. Typically, 2 to 4 percent of the overall project cost would be included for furnishing and non-fixed equipment costs in a project of this scale and complexity, which would be \$1.1-2.2 million. Anticipated budget request is \$1.4 million (Attachment D.)
2. Donation acceptance. City Council's formal acceptance of donations is requested as well as direction to City staff for recognizing the donations. Total donated funds currently available for City Council to accept toward the MPCC: \$850,000
 - A. In 2021, partner nonprofit organizations Friends of Menlo Park Library and Menlo Park Library Foundation committed cash donations of \$300,000 each (\$600,000 total) toward the City's costs for library furniture, artwork, books and equipment in the MPCC. These two donations comprise 60 percent of the Menlo Park Library Foundation's fundraising goal, still in progress, of raising \$1 million toward the MPCC project.
 - B. In 2019, the Maria S. Hoffman Trust donated \$250,000 toward the Menlo Park Senior Center, a one-time bequest which may be used to offset startup costs for furnishing and equipping the MPCC

senior center, makerspace and dining hall.

3. Interim services extension. Budget adjustments are needed to cover the costs of extending the lease on the youth center portables and other extended duration interim services costs due to changes in the MPCC construction schedule, for example transportation services. Anticipated amount is \$50,000.

MPCC project enhancements cost escalation

In late 2020, the City Council provided direction to include 10 project enhancements to the MPCC project. The 2020 cost estimates for the design and construction totals are shown in Table 1. City staff has been advised by Meta and the general contractor, Level 10 Construction, of cost escalations that will exceed the City's previously committed \$13.464 million financial contribution toward the project for these City-requested enhancements. Staff has already applied cost savings from items for which costs were less than anticipated than the 2020 estimates (approximately \$1.4 million), but the resulting cost escalation as of March 2023 (indicated in Table 1) ultimately exceeds the prior \$13.464 million estimate.

City staff is requesting that the City Council appropriate \$1.125 million in funding for these items, which accounts for all items except No. 6, the renewable energy microgrid. Total costs with and without this estimate are shown in Table 1 below for reference and further explanation follows the table.

Table 1: MPCC project enhancements cost escalation			
Item	2020 Cost estimate	Anticipated escalation	Subtotal
1. New swimming pool	\$7.400 million	\$0.980 million	\$8.38 million
2. Red Cross evacuation center	\$0.750 million	\$0	\$0.750 million
3. Emergency backup power (diesel generator)	\$0.150 million	\$0	\$0.150 million
4. Solar carports	\$1.500 million	\$0.05 million	\$1.55 million
5. LEED Platinum (Leadership in Energy and Environmental Design) upgrade plus additional rooftop solar	\$0.600 million	\$0	\$0.600 million
6. Renewable energy microgrid (battery backup)*	\$1.200 million	\$1.4-1.7 million	\$2.6-2.9 million
7. Building deconstruction versus demolition	\$0.400 million	\$0.05 million	\$0.45 million
8. Water main replacement	\$0.800 million	\$0.01 million	\$0.81 million
9. Recycled water connection from Chilco Street	\$0.414 million	\$0.035 million	\$0.449 million
10. Utility undergrounding	\$0.250 million	\$0	\$0.25 million
Subtotal (not including item 6)	\$12.264 million	\$1.125 million	\$13.389 million
Total (including item 6)*	\$13.464 million	\$2.525 – 3.825 million	\$14.864 – 15.164 million

*See text summary below for further description of this item. Not recommended for funding as part of this request, but is included for context and information purposes. For transparency, an additional contract for the design and construction of the microgrid was authorized by the City Council in January 2021 with ENGIE Services US Inc. which is separate from the agreement with Meta summarized here

For item six, the anticipated additional cost is shown as a range, as the cost estimates are still in development. In addition, these costs have not yet been allocated between Meta and the City, and staff is continuing to negotiate this amount. This escalation is due to delay in receiving a piece of electrical

equipment (switchgear) that is necessary to provide a permanent electricity connection for the building, as described in the Background section above. Some construction activities (such as installing the gymnasium floor, which requires the heating/cooling system to provide temperature control) should not be done until permanent power is established. Therefore, staff and Meta are completing a detailed review of the project schedule by task to determine the most expedient, cost effective path forward while ensuring the building materials are adequately protected. Because this work is ongoing, staff recommends returning to the City Council with an update on the cost impact of this enhancement and associated appropriation request at a future date.

In addition to the 10 City-requested enhancements in Table 1, the City is also responsible for costs associated with City-requested changes for site improvements and gymnasium improvements that were not anticipated at the time construction began. These include opportunities to align construction activities for some of the facility and site improvements in surrounding Kelly Park (installing new site fencing, soccer nets, scoreboards, volleyball system, security system, etc.) These three items total approximately \$0.50 million.

Summary

Table 2 below summarizes the expenses, donations and total budget amendment request.

Table 2: MPCC project budget amendment summary			
Category	Description	Added revenue	Added expenses
Donations	Partner nonprofit organizations Friends of Menlo Park Library and Menlo Park Library Foundation have committed combined total cash donations of \$600,000. The Maria S. Hoffman Trust has donated \$250,000	\$0.85 million	
Furniture and non-fixed equipment	Furniture, fitness equipment, library automated book sorter and other non-fixed items necessary for building opening in 2024		\$1.40 million
Interim services extension	Extending the lease and associated services on the youth center portables and senior transportation services in alignment with the new project completion schedule in early 2024		\$0.05 million
Cost escalation for City-requested enhancements	Cost escalation and additional costs as summarized in Table 1		\$1.125 million
City modifications	Site and gymnasium improvements at the facility and in surrounding Kelly Park		\$0.50 million
Total		\$0.85 million	\$3.15 million

Future requests

As described above, staff anticipates returning to the City Council for an appropriation for the additional costs related to the renewable energy microgrid and electrical equipment at a future date with an anticipated cost of up to \$1.7 million. At that time, staff also anticipates to bring forward a recommended contingency budget in order to complete the City-requested enhancements and any additional requests. No contingency was previously authorized for the project, though typically, contingency of 10 to 20 percent would be included in a project of this scale and complexity. Based on the City's original budget of \$15.75 million for the project, this would result in contingency of the range \$1.57 to \$3.14 million. Staff will be working with Meta and the construction team to identify remaining items requiring additional contingency for a future

request. Currently, staff anticipates this amount is \$1-2 million.

Related items on the March 14 City Council agenda

- Midyear budget amendment. Includes an amendment to the salary schedule, with no net change to the City's total full-time equivalent (FTE) head count, to update job classifications to support planning for the opening of the MPCC facility
- Resolution to update City Council Procedure CC-86-0001, "Naming and/or changing the name of facilities." City Council January 24 identified a timeline for the MPCC facility naming process. Due to the impacts of the recent widespread power outages in Menlo Park, which may have prevented some community members from attending the Parks and Recreation Commission (PRC) study session February 22, staff recommends extending the overall timeline by approximately four additional weeks
- Belle Haven School renovation project update. On March 22, Ravenswood City School District staff provided a presentation to the Parks and Recreation Commission (PRC) of preliminary options to redesign the field area on the north side of the school campus, with the intent to make that area more accessible and beneficial to Belle Haven neighborhood residents.

Aquatics center - air source heat pumps and noise ordinance exception

The Planning Commission (PC) held a public hearing February 27, which had been continued from a previous October 22, 2022 hearing, to consider a use permit application to exceed nighttime noise limits to accommodate electric pool heating equipment at the MPCC. As previously reported to City Council, air source heat pumps are an all-electric method of pool heating, and specifically the method that meets requirements for effectively heating the MPCC aquatics centers' lap and instructional pools, consistent with City goals of greenhouse gas reduction and air quality improvements. Extensive study and effort to minimize the noise that would be generated by the pool heating equipment found that the equipment may exceed the nighttime noise limits of 50 decibels measured at the nearest residential property line, absent additional attenuation efforts such as sound walls or installing fencing or other screening. On February 27 the PC continued the item to a future meeting, but indicated an intention to deny the use permit application, citing potential noise impacts to nearby residential properties. A potential next step in the process would entail City staff preparing findings of denial for formal adoption by the PC tentatively March 27. If the PC denies the application, the City may appeal to the City Council or the City Council could call-up the decision per municipal code §16.86.025. In parallel staff is continuing to explore options to reduce the noise and to understand the operational impacts of potential reduced pool hours if the exception is not approved.

Parking management plan update

The Complete Streets Commission (CSC) held a study session December 14, 2022, to review considerations for a parking management plan related to the MPCC parking areas. The CSC reviewed preliminary options including: time limited parking to ensure parking is available for short term visitors; designating certain parking spaces during certain times of day for different types of visitors such as seniors and Beechwood School students; potentially restricting or placing limits of overnight parking such as a pre-defined "exit" time so overnight parking is less likely to impact early morning users; the quantity and location of bicycle parking, pedestrian routes; and other factors that pertain to the management of the parking area. Key elements of the planning process include: review relevant past parking studies and data; conduct public outreach to gather community input; develop a draft plan for review by the CSC in May; then present a final draft plan to City Council review and approval tentatively in summer 2023.

Impact on City Resources

Staff estimates the value of Meta's contribution toward the MPCC project completion at approximately \$40 million. The City's share of the project construction includes commitments at both a base level and project

enhancements totaling approximately \$15.75 million from various funding sources authorized by the City Council in prior actions. On July 28, 2020, the City Council approved the five-year capital improvement plan which allocated \$3.85 million in funds plus carry-over funds of \$2.13 million for a total base project budget of \$5.98 million. On November 5, 2020, the City Council authorized an additional \$9.8 million to fund the City-requested enhancements to the project for a total project budget of approximately \$15.75 million. This amount was identified to cover the City's contribution to design and construction activities in addition to Meta's contribution, interim services and staff time to support the project. In addition, the City also has entered into a separate contract with ENGIE Services US Inc. in the amount of \$5.72 million for the design and construction of the microgrid after the City Council authorization in January 2021.

As described above, staff is seeking an additional \$3.15 million in funding for the project to account for new expenses as the building nears completion and opening, as well as for cost escalation on previously identified City-requested enhancements. Approximately \$0.85 million would be offset by donations from Friends of the Menlo Park Library, Menlo Park Library Foundation, and the Maria S. Hoffman Trust. The anticipated net impact of these actions is \$2.225 million.

Table 3 below summarized the funding sources previously identified for this project from prior City Council authorizations, as well as this additional \$2.225 million. The remaining \$2.225 million in funding is available from the fund balance for the recreation in-lieu fee fund. Total recreation in-lieu fee funding, including prior authorizations, is \$3.795 million.

Table 3: City-share funding sources	
Source	Amount (\$ million)
General fund CIP	\$2.098
Library system improvement fund	\$1.484
Recreation in lieu fund	\$3.795 ¹
Water capital fund	\$0.800
Park and Water Bond Act of 2018 (Proposition 68) grant	\$0.198
Grants and donations (total target \$1.000 million)	\$0.850
Measure T general obligation recreation bonds	\$8.800
Total	\$18.025

¹ \$1.570 prior appropriation + \$2.225 this request

Future operating and staffing cost considerations

The ongoing cost impacts of operating the new facility will be established over the next several months as part of the MPCC operational planning process. As part of the new facilities opening, it is anticipated that existing services that are currently housed in interim locations will be relocated to the new facility; some services that were suspended or reduced during the MPCC construction and/or due to pandemic impacts would likely be restored to pre-construction/pre-pandemic levels; and some service level enhancements could be necessary or desired in order to operate the facility in the manner and capacity envisioned by the City Council and the community. The intent is to engage the community over the next several months through the MPCC operational planning process to identify what is desired regarding the facility's programs and operations, which can then inform projected operating costs for the City Council to make budgeting decisions for fiscal year 2023-24.

As reported to City Council January 24, City staff is developing a detailed staffing proposal to support ongoing MPCC programs and operations when the new facility opens to the public in 2024 (Attachment E.) The MPCC staffing proposal is being developed for City Council review and potential authorization in the context of the fiscal year 2023-24 budget adoption process, and will be informed by multiple factors including but not limited to: input from the City Council and MPCC subcommittee and working group; the recently completed survey of community needs and desired programs; past staffing to support pre-MPCC construction and pre-pandemic operations; current staffing to support interim services that will relocate to MPCC (senior center, youth center, library); new staffing to support desired new programs and services in the MPCC that have not been provided before such as the makerspace and teen lounge, and to support an expanded public library space that spans two floors instead of one; and to accommodate an anticipated significant increase in overall usage which is commonly experienced when new facilities open to the public. Based on these considerations, City staff preliminarily estimates that approximately 4-5 full-time equivalent (FTE) new staff, in addition to new temporary personnel, will be needed to support the gymnasium, recreation center, makerspace, teen lounge, expanded library space, and other desired new programs when the MPCC opens in 2024. The fiscal year 2023-24 MPCC staffing proposal will outline the requested additional FTEs in detail for City Council consideration and authorization.

Environmental Review

On January 12, 2021, the City Council found the MPCC project categorically exempt pursuant to the California Environmental Quality Act (CEQA) Guidelines §15302 Replacement of Existing Facilities. The project has substantially the same purpose and capacity as the existing facilities, and this exemption allows for reasonable increases in square footage to accommodate replacement facilities. On January 21, 2021, staff filed a notice of exemption with the San Mateo County clerk.

Public Notice

Public notification was achieved by posting the agenda, with the agenda items being listed, at least 72 hours prior to the meeting. In addition, the City sent electronic notices directly to project email and text update subscribers from the project page (Attachment A.)

Attachments

- C. Hyperlink – Project page: menlopark.gov/communitycampus
- D. Hyperlink – Subscription page: menlopark.gov/subscribe
- E. Hyperlink – September 13, 2022, City Council agenda: menlopark.gov/files/sharedassets/public/agendas-and-minutes/city-council/2022-meetings/agendas/20220913-city-council-agenda-packet.pdf#page=6
- F. Furniture and non-fixed equipment estimate
- G. Hyperlink – January 24, City Council agenda: menlopark.gov/files/sharedassets/public/agendas-and-minutes/city-council/2023-meetings/agendas/20230124-city-council-agenda-packet.pdf#page=129

Report prepared by:

Nikki Nagaya, Deputy City Manager

Sean S. Reinhart, Library and Community Services Director

Menlo Park Community Campus
Furnishing and non-fixed equipment estimates
Updated February 28, 2023

Code	Name	Manufacturer	Model	Qty	Unit Cost	Extension	New Furniture Est. Discounted Price
C-1	Adult Reader Chair	Naughtone	Viv Wood Base	36	\$ 2,621.00	\$ 94,356.00	\$ 56,613.60
C-2	Task Chair	Naughtone	Viv 5-star Base with Arms	10	\$ 2,080.00	\$ 20,800.00	\$ 12,480.00
C-3	Stacking Chair	Herman Miller	Pronta	150	\$ 500.00	\$ 75,000.00	\$ 45,000.00
C-4	Classroom Chair	Naughtone	Viv 4-leg base no arms	18	\$ 1,535.00	\$ 27,630.00	\$ 16,578.00
C-5	Child Reader Chair - Large	Enea	Lotus 15"	78	\$ 270.00	\$ 21,060.00	\$ 12,636.00
C-6	Child Reader Chair - Small	Enea	Lotus 12"	8	\$ 250.00	\$ 2,000.00	\$ 1,200.00
C-7	Makerspace Stool	Hightower	Jaxson	36	\$ 900.00	\$ 32,400.00	\$ 19,440.00
C-8	Teen Stool	Steelcase	Turnstone Scoop	6	\$ 702.00	\$ 4,212.00	\$ 2,527.20
C-9	2nd Floor Hallway Seating	Sedia	Jump seat wall mount	5	\$ 1,323.00	\$ 6,615.00	\$ 3,969.00
C-10	Staff Task Chair	Herman Miller	Aeron (additional chairs not at workstations)	6	\$ 841.00	\$ 5,046.00	\$ 3,027.60
T-1	Adult Reader Table - Square	Steelcase	Verlay 42" x 42" (w/ power and cable	5	\$ 5,610.00	\$ 28,050.00	\$ 16,830.00
T-2	Adult Reader Table	Steelcase	Verlay 72" x 42" (w/ power and cable	5	\$ 6,617.00	\$ 33,085.00	\$ 19,851.00
T-3	Conference Table	Steelcase	Verlay 48" x 144" Rectangle with trestle metal power and cable management)	1	\$ 8,531.00	\$ 8,531.00	\$ 5,118.60
T-4	Breakroom Table	Steelcase	Verlay 42" x 84" (no power)	1	\$ 6,700.00	\$ 6,700.00	\$ 4,020.00
T-5	Round Folding Table	Souther Aluminium	Idesign	15	\$ 900.00	\$ 13,500.00	\$ 8,100.00
T-6	Flip Top Table - Chevron	Steelcase	Verb Chevron 30" x 60"	5	\$ 1,924.00	\$ 9,620.00	\$ 5,772.00
T-7	Flip Top Table - Rectangle	Steelcase	Verb Rectangular 30" x 60"	18	\$ 1,860.00	\$ 33,480.00	\$ 20,088.00
T-8	Childrens Flip Top Table	KI	Trek Flip top table (custom 25" height)	12	\$ 1,444.00	\$ 17,328.00	\$ 10,396.80
T-9	Teen Table	Steelcase	Flex	2	\$ 2,381.00	\$ 4,762.00	\$ 2,857.20
T-10	Teen Personal Table	Coalesse	Lagunitas	2	\$ 819.00	\$ 1,638.00	\$ 982.80
T-11	Teen Coffee Table	Coalesse	Lagunitas	1	\$ 2,636.00	\$ 2,636.00	\$ 1,581.60
T-12	Side Table	Herman Miller	Nelson	3	\$ 1,071.00	\$ 3,213.00	\$ 1,927.80
T-13	Coffee Table	Herman Miller	Noguchi Rudder	3	\$ 2,137.00	\$ 6,411.00	\$ 3,846.60
T-14	Laptop Table	Steelcase	Turnstone Campfire	4	\$ 400.00	\$ 1,600.00	\$ 960.00
T-15	Children's Round Table - Small	Freshcoast	Quince 36" Round 20" High	2	\$ 1,348.00	\$ 2,696.00	\$ 1,617.60
T-16	Children's Round Table - Med	Freshcoast	Quince 36" Round 25" High	2	\$ 1,401.00	\$ 2,802.00	\$ 1,681.20
T-17	Makerspace Table	3Branch	Maker Flex	6	\$ 2,100.00	\$ 12,600.00	\$ 7,560.00
L-1	Adult Single Lounge	Naughtone	Hush Low	4	\$ 4,753.00	\$ 19,012.00	\$ 11,407.20
L-2	Adult/Senior Single Lounge	Sossego	Beatriz	8	\$ 3,600.00	\$ 28,800.00	\$ 17,280.00
L-3	Senior Lounge Sofa	Sossego	Beatriz (3 Seat Sofa)	1	\$ 4,500.00	\$ 4,500.00	\$ 2,700.00
L-4	Lobby Bench	Coalesse	Together Backless	2	\$ 4,800.00	\$ 9,600.00	\$ 5,760.00
L-5	Lobby Lounge	Naughtone	Rhyme (2 Bench + 2 Low Back End A)	1	\$ 32,000.00	\$ 32,000.00	\$ 19,200.00
L-6	Teen Sofa	Steelcase	Lagunitas 3 seat lounge, 3 seat chaise, low	1	\$ 12,269.00	\$ 12,269.00	\$ 7,361.40
L-7	Teen Single Lounge	Naughtone	Fiji	2	\$ 6,427.00	\$ 12,854.00	\$ 7,712.40
L-8	Aftercare Bench Seating	KI	Myplace 45 Degree Curve	6	\$ 1,500.00	\$ 9,000.00	\$ 5,400.00
L-9	Aftercare Lounge	Bernhardt	Diego	2	\$ 3,800.00	\$ 7,600.00	\$ 4,560.00
L-10	Children's Loveseat	Naughtone	Hush Highback	2	\$ 10,777.00	\$ 21,554.00	\$ 12,932.40
L-11	Children's Ottoman	Hightower	Nimbus Jr. w/ point	6	\$ 1,800.00	\$ 10,800.00	\$ 6,480.00
WS-1	Private Office (1st Floor)	Herman Miller	Canvas (includes chair)	1	\$ 5,585.00	\$ 5,585.00	\$ 5,585.00
WS-2	Private Office (2nd Floor)	Herman Miller	Canvas (includes chair)	1	\$ 6,510.00	\$ 6,510.00	\$ 6,510.00
WS-3	Staff Workstation	Herman Miller	5 x 5 Canvas workstation (includes chair)	14	\$ 4,902.50	\$ 68,635.00	\$ 68,635.00
WS-4	Adult Collection Circ Desk	Creative Wood	Custom	1	\$ 12,535.00	\$ 12,535.00	\$ 12,535.00
WS-5	Adult Collection Self Check Desk	Creative Wood	Custom	1	\$ 5,734.00	\$ 5,734.00	\$ 5,734.00
WS-6	Children's Library Circ Desk	Creative Wood	Custom	1	\$ 19,600.00	\$ 19,600.00	\$ 19,600.00
A-1	Children's Art	Magis	Fish	6	\$ 300.00	\$ 1,800.00	\$ 1,080.00
A-2	Trash Can - Lobby	Scandinavian Spaces	Kite (3 bins for one unit)	6	\$ 2,799.00	\$ 16,794.00	\$ 10,076.40
A-3	Senior Room Separator	Herman Miller	OE1 Agile Wall (2 Shelving 1 Panel Wall)	1	\$ 14,587.00	\$ 14,587.00	\$ 8,752.20
A-4	Lectern	Coalesse	Exponents Lectern	1	\$ 5,300.00	\$ 5,300.00	\$ 3,180.00
A-5	Stacking Chair Cart	Herman Miller	Pronta Cart	4	\$ 860.00	\$ 3,440.00	\$ 2,064.00
A-6	Round Folding Table Cart	Southern Aluminum	GHD Table Trucks	3	\$ 2,121.00	\$ 6,363.00	\$ 3,817.80
A-7	Power Tower	KI	Isle Power Tower	3	\$ 2,353.00	\$ 7,059.00	\$ 4,235.40
S-1	Mobile Book Shelves	Esteey	45" High, 36" Wide concealed caster	22	\$ 2,208.00	\$ 48,576.00	\$ 48,576.00
S-2	Wire Shelving Small	Global Industrial	5-Tier Nexel ESD Wire Shelving (24 in. W x 74	3	\$ 200.00	\$ 600.00	\$ 600.00
S-3	Wire Shelving Medium	Global Industrial	5-Tier Nexel ESD Wire Shelving (48 in. W x 74	6	\$ 277.00	\$ 1,662.00	\$ 1,662.00
S-4	Wire Shelving Large	Global Industrial	5-Tier Nexel ESD Wire Shelving (48 in. W x 74	44	\$ 312.00	\$ 13,728.00	\$ 13,728.00
S-5	Fitness storage (resistance band	Amazon	Multi purpose hanging band rack	2	\$ 40.00	\$ 80.00	\$ 80.00
S-6	Handweight racks	Global Industrial	Power Systems Premium Dumbbell Storage	1	\$ 1,182.00	\$ 1,182.00	\$ 1,182.00
E-1	Book drop	Bibliotheca	Flat front RFID lock AMH51003-000	1	\$ 22,122.00	\$ 22,122.00	\$ 22,122.00
E-2	Automatic Sorter	Bibliotheca	3 bin 1 sided external induction	1	\$ 74,547.00	\$ 74,547.00	\$ 74,547.00
E-3	Self Check	Bibliotheca	Self Check 1000	3	\$ 12,074.00	\$ 36,222.00	\$ 36,222.00
E-4	RFID Workstations	Bibliotheca	RFID Workstation shielded	3	\$ 883.00	\$ 2,649.00	\$ 2,649.00
E-5	Barcode Scanner	Global Industrial	Datalogic 1D/2D Cordless Multi Interface	3	\$ 573.00	\$ 1,719.00	\$ 1,719.00
E-6	RFID Gate	Bibliotheca	Floor mounted with hidden wiring and detection	1	\$ 11,922.00	\$ 11,922.00	\$ 11,922.00
	Library Connect devices	Bibliotheca		1	\$ 2,348.00	\$ 2,348.00	\$ 2,348.00
	Bibliotheca Shipping / Admin	Bibliotheca		1	\$ 18,086.00	\$ 18,086.00	\$ 18,086.00
E-7	Leg extension / curl	True Fitness	SD-1000 Leg Extension/Leg Curl	1	\$ 3,400.00	\$ 3,400.00	\$ 3,400.00
E-8	Smith Machine	True Fitness	XFW-6800 Smith Machine	2	\$ 3,900.00	\$ 7,800.00	\$ 7,800.00
E-9	Leg Press	True Fitness	XFW-7800 Leg Press	1	\$ 5,000.00	\$ 5,000.00	\$ 5,000.00
E-10	Upright Bike	True Fitness	TRUE CS400 Upright Bike	1	\$ 2,600.00	\$ 2,600.00	\$ 2,600.00
E-11	Elliptical	True Fitness	TRUE Performance 300 Elliptical	1	\$ 4,300.00	\$ 4,300.00	\$ 4,300.00
E-12	Treadmill	True Fitness	TRUE CS900 Commercial Treadmill	3	\$ 10,220.00	\$ 30,660.00	\$ 30,660.00
E-13	Stairmaster	StairMaster	Stairmaster Gauntlet 10G Stepmill	1	\$ 9,500.00	\$ 9,500.00	\$ 9,500.00
E-14	Dual Stack Functional Trainer	TuffStuff	TuffStuff Dual Stack Functional Trainer (MFT-	1	\$ 6,300.00	\$ 6,300.00	\$ 6,300.00
E-15	Fitness Stretch	True Fitness	TRUE Stretch	1	\$ 2,700.00	\$ 2,700.00	\$ 2,700.00
E-16	Adjustable Bench	True Fitness	Hammer Strength Multi-adjustable Bench	6	\$ 2,000.00	\$ 12,000.00	\$ 12,000.00
E-17	Hoist Fitness Tree	Hoist	HF-5962 Fitness Tree	1	\$ 900.00	\$ 900.00	\$ 900.00
E-18	Dumbbell Rack	Hoist	12 pair Saddle Beauty Bell Dumbbell Rack	2	\$ 830.00	\$ 1,660.00	\$ 1,660.00
O-1	Outdoor Bench	Country Casual	Bond 6' Backless	6	\$ 1,217.00	\$ 7,302.00	\$ 4,381.20
O-2	Outdoor Lounge	Lolli Design	Lollygagger	8	\$ 645.00	\$ 5,160.00	\$ 3,096.00
O-3	Outdoor Chaise	Lolli Design	Lollygagger	6	\$ 1,395.00	\$ 8,370.00	\$ 5,022.00
O-4	Outdoor Chaise - Stacking	Janus et Cie	Duo Stackable	12	\$ 1,136.00	\$ 13,632.00	\$ 8,179.20
O-5	Outdoor Chair	Design within Reach	Sustainable Lisboa Chair	100	\$ 235.00	\$ 23,500.00	\$ 14,100.00
O-6	Outdoor Table	EMU	Round Square Table	37	\$ 910.00	\$ 33,670.00	\$ 20,202.00
O-7	Outdoor Umbrella	Country Casual	9 ft Square w/ square 90 lb base	8	\$ 2,643.00	\$ 21,144.00	\$ 21,144.00
O-8	Children's Outdoor Lounge	Plank	Land Lounge	4	\$ 1,200.00	\$ 4,800.00	\$ 4,800.00
O-9	Children's Outdoor Stones	Concrete Works	Soma Stones	6	\$ 2,000.00	\$ 12,000.00	\$ 7,200.00
O-10	Picnic Table	Extremis	Picnik	5	\$ 8,790.00	\$ 43,950.00	\$ 26,370.00
O-11	Makerspace Outdoor Table	Extremis	Hopper AA 240 (6 Person)	4	\$ 11,420.00	\$ 45,680.00	\$ 27,408.00
O-12	Outdoor Side Table	Lolli Design	Lollygagger Side Table	7	\$ 245.00	\$ 1,715.00	\$ 1,029.00
Product Subtotal						\$ 1,362,888.00	\$ 1,004,455.20
Freight/Installation (15%):							\$ 150,668.28
Contingency (10%):							\$ 100,445.52
PROJECT SUBTOTAL:							\$ 1,255,569.00
Tax (9.5%):							\$ 119,279.06
PROJECT GRAND TOTAL							\$ 1,374,848.06

SITE PLAN

- CHAIR
- TABLE
- LOUNGE
- OUTDOOR
- ACCESSORIES
- STORAGE
- WORKSTATIONS
- EQUIPMENT

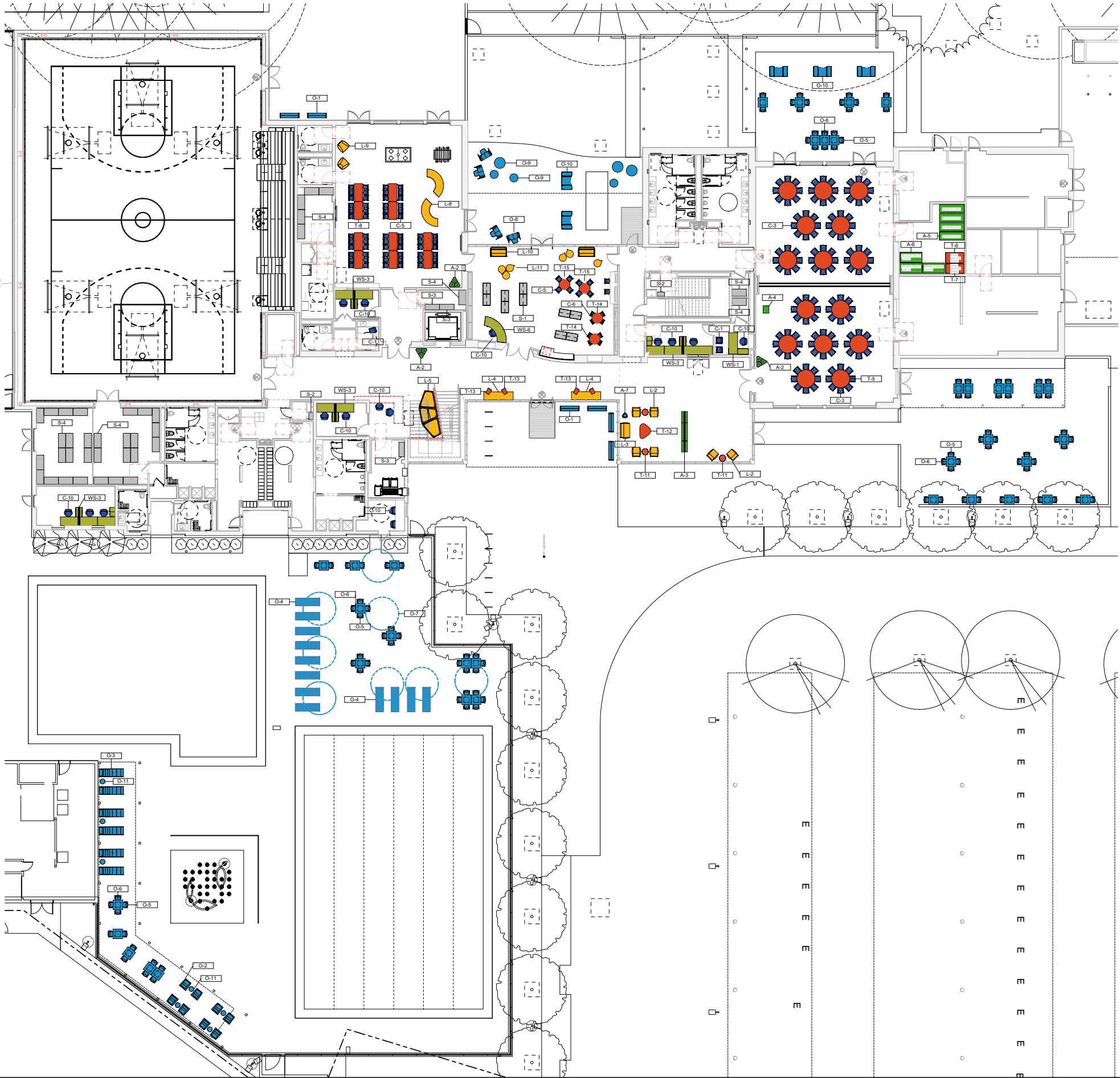

FIRST FLOOR

- CHAIR
- TABLE
- LOUNGE
- OUTDOOR
- ACCESSORIES
- STORAGE
- WORKSTATIONS
- EQUIPMENT



SITE PLAN

- CHAIR
- TABLE
- LOUNGE
- OUTDOOR
- ACCESSORIES
- STORAGE
- WORKSTATIONS
- EQUIPMENT

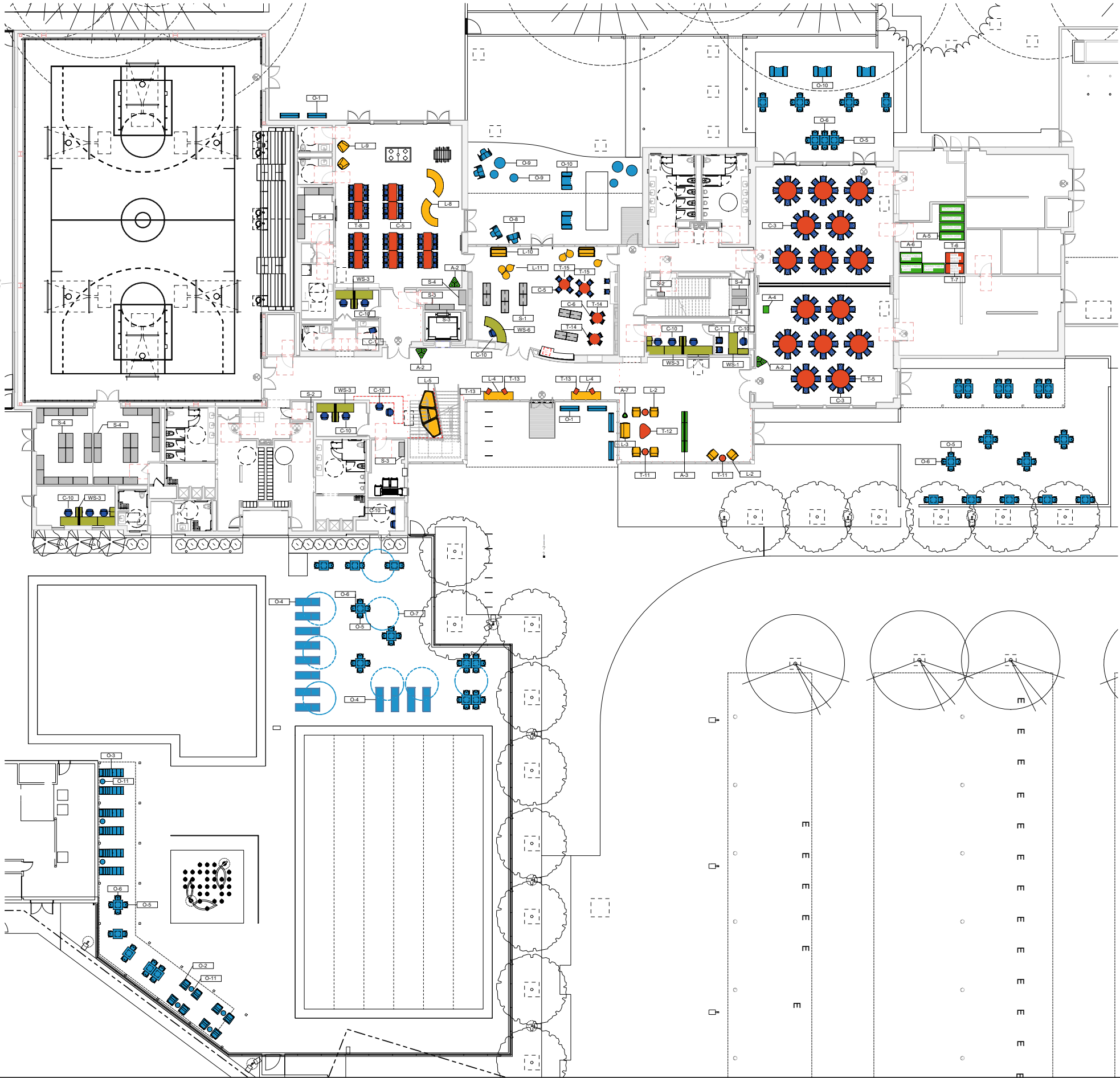

FIRST FLOOR

- CHAIR
- TABLE
- LOUNGE
- OUTDOOR
- ACCESSORIES
- STORAGE
- WORKSTATIONS
- EQUIPMENT



SECOND FLOOR

- CHAIR
- TABLE
- LOUNGE
- OUTDOOR
- ACCESSORIES
- STORAGE
- WORKSTATIONS
- EQUIPMENT

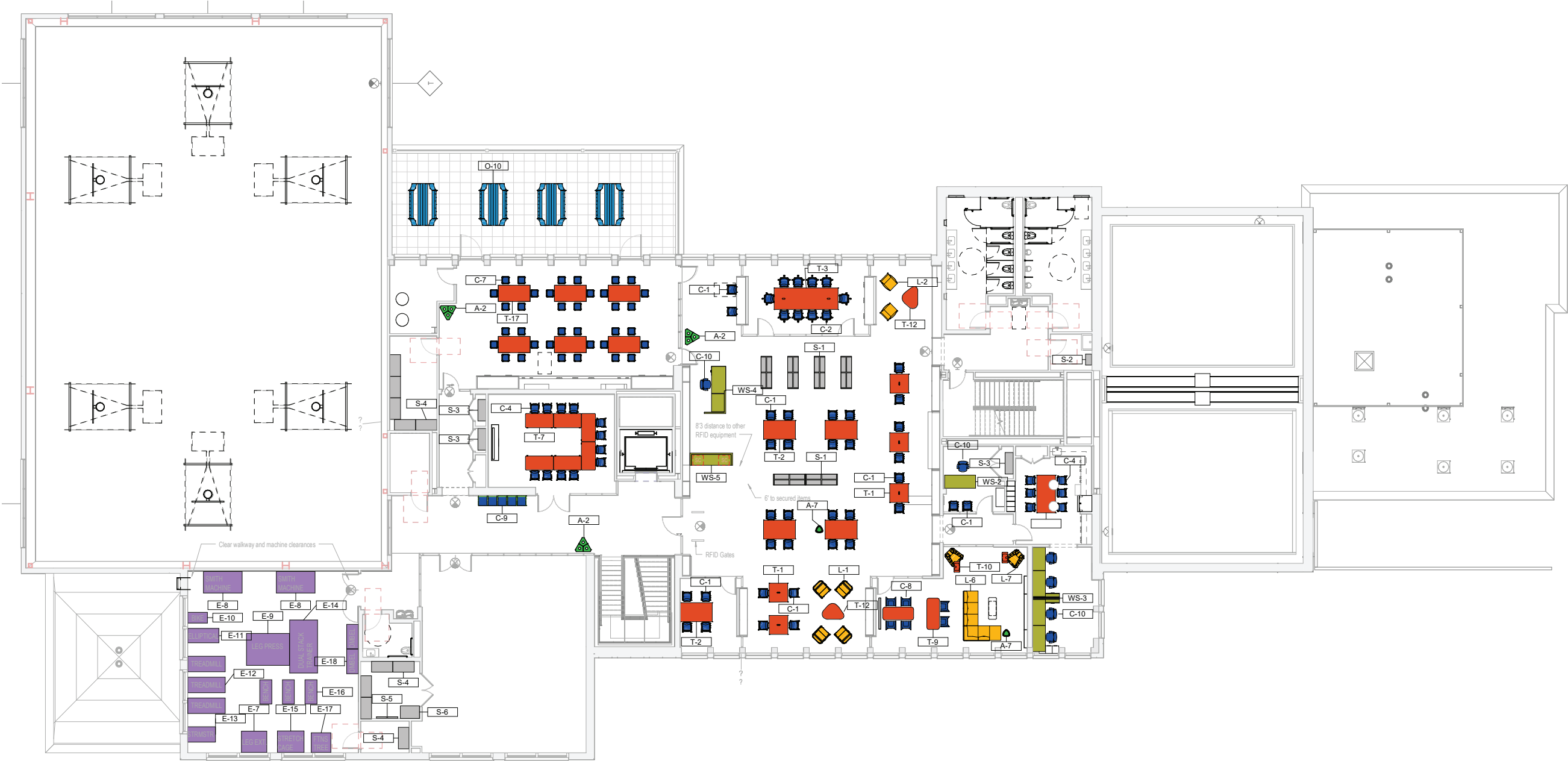

ADULT READER CHAIR**Naughtone - Viv Wood Base****DESCRIPTION****QUANTITY:** 36**SIZE:** 30.5"H x 22"D x 20.5"W**STYLE:** Fully upholstered with wood base

NOVWN-100-WLN-PG

LOCATION: (32) Adult Collections
 (2) Private Office Rm. 136
 (2) Private Office Rm. 227

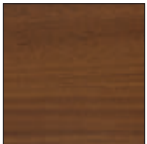
BASE: Solid Walnut**ARMS:** None**UPHOLSTERED SEAT/BACK:**

Designtex, Bigdot in Cinnamon
 3525-301



TASK CHAIR

Naughtone - Viv 5-star Base with Arms



DESCRIPTION

QUANTITY: 10

SIZE: 31”H x 21”D x 25”W X 17.75” SH

STYLE: Five star swivel base with arms, polished chrome base finish, fully upholstered, hard casters

NOVVN-701-L-POL-HC

LOCATION: Conference Room

FRAME: Polished Chrome

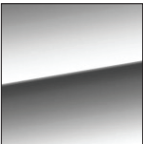

ARMS: Polished Chrome

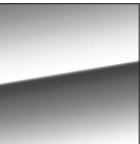

UPHOLSTERED SEAT/BACK:

Designtex, Bigdot in Cinnamon
3525-301



STACKING CHAIR

Herman Miller - Pronto



DESCRIPTION

QUANTITY: 150

SIZE: 20.95"W x 23.12"D x 31.86"H
14"SH

STYLE: Stacking chair, seat and powder coated
frame in peacock with standard glides

JOS-PBL-PBL-SG

LOCATION: Senior Dining / Community Event Room

SEAT AND FRAME:
Herman Miller, Peacock



CLASSROOM CHAIR**Naughtone - Viv 4-leg base no arms**

DESCRIPTION

QUANTITY: 18**SIZE:** 22"W x 32"H x 21.5"D X 17.5" SH**STYLE:** 4-leg base, no arms, fully upholstered, with polished chrome base and plastic glides

NOVVN-150-CHR-PG

LOCATION: (12) Flex Classroom
(6) Staff Breakroom

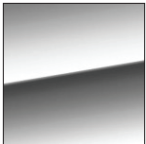
FRAME: Polished Chrome**ARMS:** None**UPHOLSTERED SEAT/BACK:**

Designtex, Bigdot in Cinnamon 3525-301

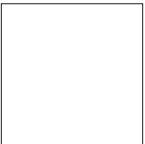

CHILD READER CHAIR LARGE**Enea - Lottus Children****DESCRIPTION****QUANTITY:** 70**SIZE:** 20"W x 16.9"D x 23.2"H**STYLE:** Children's chair, frame and shell in White, seat pad in red, with felt glides**LOCATION:** (10) Children's Library
(60) Youth Center**FRAME:** White**SEATPAD:**

Luna textiles, Boink in Zing, BNK-5491

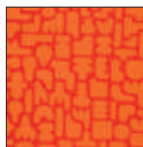
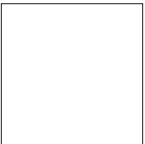
**SEAT:** White

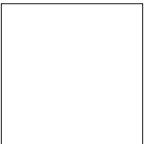
CHILD READER CHAIR SMALL**Enea - Lottus Children****DESCRIPTION****QUANTITY:** 8**SIZE:** 19.3"W x 16.9"D x 20"H**STYLE:** Children's chair, frame and shell in White, seat pad in red, with felt glides**LOCATION:** (8) Children's Library**FRAME:** White**SEATPAD:**

Luna textiles, Boink in Zing, BNK-5491

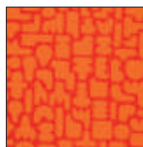
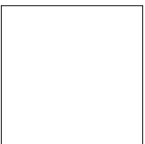
**SEAT:** White

MAKERSPACE STOOL

Hightower - Jaxson Bar Stool



DESCRIPTION

QUANTITY: 36
18 Counter
18 Low

SIZE: Counter: 16.25"W x 16.25"D x 24"H
Low: 14"W x 16.25"D x 18"H

STYLE: Bar stool with solid ash seat and navy mood frame

SS100 (Low)
SS150 (Counter)

LOCATION: Makerspace

FRAME: Navy Mood



SEAT: Solid Ash



TEEN STOOL

Steelcase - Turnstone Scoop



DESCRIPTION

QUANTITY: 4

SIZE: 23"W x 20.25"D x 33"H

STYLE: Bar stool with upholstered seat and soft glides
TS30701

LOCATION: Teen Room

FRAME: Steelcase Paint in Platinum Metallic 4799



SEAT: Steelcase Seating Plastic in Blue 6BC5



Sedia - JumpSeat Wall



QUANTITY: 5

SIZE: 19.75"W x 4"D x 38"H
18.25"D With seat down
6" Mounting height AFF to bottom of chair

STYLE: Wall mount, white oak veneer surface finish with vinyl upholstered seat. (2) In bluebird, (2) in azure, (1) in Sanctuary.

In order, bluebird, azure, sanctuary, bluebird, azure.

LOCATION: Second Floor Corridor (201)

UPHOLSTERED SEAT: (1) Spradling vinyl
Modena in Sanctuary MOD-2009



UPHOLSTERED SEAT: (2) Spradling vinyl
Modena in Azure MOD-2011



UPHOLSTERED SEAT: (2) Spradling vinyl
Modena in Bluebird MOD-2002



SURFACE: White oak veneer

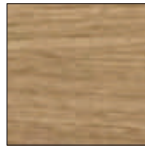

PLAN: Not to scale. Seats centered on wall, 22" min center to center spacing

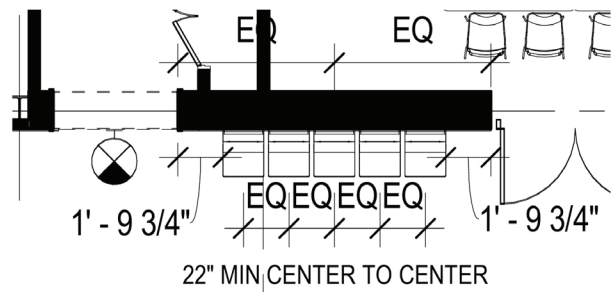

STAFF TASK CHAIR

Herman Miller - Aeron Work Chair, Ready to Assemble



DESCRIPTION

QUANTITY:

22

SIZE:

28.3-30.4"W x 27.5-28.3"D x 36.75-41.13"H

STYLE:

Work Chair, New Aeron, B Size, Low Height range adjustable, Standard tilt, Fixed arms, Non upholstered arm pads

AER1B1PW-SZS-G1-G1-G1-BB-BK-231-03

LOCATION:

First floor:

(3) Lifeguard Staff 129
(2) YC Staff 109
(2) Reception Desk
(1) Children's Library
(2) Pool staff
(3) Senior Staff 134
(1) Private office 136

Second floor:

(1) Adult Collections
(3) Staff office 223
(1) Private Office 227

PELLICLE:

Black, 23105



FINISH:

Black, BK

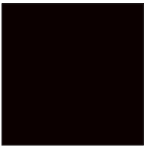

ADULT SINGLE LOUNGE

Naughtone - Hush Low



DESCRIPTION

QUANTITY: 4

SIZE: 28.5"W x 34.5"H x 30"D
17"SH

STYLE: Hush low with walnut legs and fabric upholstered internal and external , with plastic glides

NOHUN11-3-WLN-PG

LOCATION: Adult Collections

SEAT UPHOLSTERY: Momentum, Faux Mo in Delta 09200805



BASE: Natural Walnut

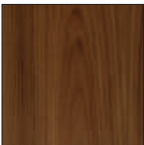

ADULT/SENIOR SINGLE LOUNGE

Sossego - Beatriz Lounge Chair



DESCRIPTION

QUANTITY: 8

SIZE: 31”H x 29.5”W x 31.1”D x 18.3”SH x 22.8”AH

STYLE: Faux leather upholstery with jequitiba wood frame, with plastic glides

LOCATION: (2) Adult Collections
(6) Senior Lounge

UPHOLSTERY: Faux Leather in Sand



BASE: Jequitiba in Tobacco Mel

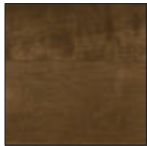

SENIOR LOUNGE SOFA

Sossego - Beatriz 3-seater Sofa



DESCRIPTION

QUANTITY: 1

SIZE: 72.8"W x 31.1"D x 31"H x 19.5"SH x 22.8"AH

STYLE: 3 Seat. Faux leather upholstery with jequitiba wood frame, with plastic glides

LOCATION: Senior Lounge

UPHOLSTERY: Faux Leather in Marine

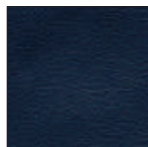

BASE: Jequitiba in Tobacco Mel

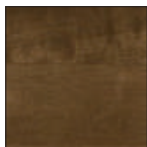

LOBBY BENCH

Coalesse - Together Straight without Back Bench



DESCRIPTION	
QUANTITY:	2
SIZE:	96.5"W x 26.75"D x 18.5"H
STYLE:	Straight without back, fully upholstered COTO96
LOCATION:	First floor lobby

UPHOLSTERY: Luum, Top Coat in Claycast 4083



LOBBY LOUNGE

Naughtone - Rhyme



DESCRIPTION

QUANTITY: 4

SIZE: Bench: 55”W x 55”D x 17.5”H
Low Back End A: 55”W x 55”D x 33.5”H x 17.5”SH

STYLE: 2 Bench and 2 Low back end A. Fully upholstered, black base. One of each lounge type in each color.

NOHRN-100-R00
NOHRN-450-R00

LOCATION: Lobby under stairs

(1) BENCH UPHOLSTERY: Designtex, Silicone Element in Tidal 3919-408



(1) LOW BACK END A UPHOLSTERY Designtex, Silicone Element in Tidal 3919-408



(1) BENCH UPHOLSTERY: Designtex, Silicone Element in Amazon 3919-411



(1) LOW BACK END A UPHOLSTERY: Designtex, Silicone Element in Amazon 3919-411



TEEN SOFA

Coalesse - Lagunitas



DESCRIPTION

QUANTITY: 1

SIZE: 15.3”W x 24.4”D x 29.9”H x 17.7”SH

STYLE: Fully upholstered lounge, one 3 seat low back with one power module (one USB/one power) and one 3 seat chaise, left hand, with one articulating back and one power module (one USB/one power)

COLAGLL31

COLAGCL3

LOCATION: Teen Room

KNIT SCREEN: Coalesse SW_1 Knit in Fire 5KG6

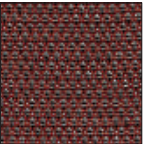

UPHOLSTERY: Knoll Premier in Blossom K229417

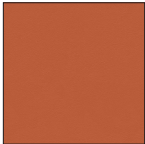

TEEN SINGLE LOUNGE**Naughtone - Fiji**

DESCRIPTION

QUANTITY: 2**SIZE:** 33.5"W x 35"H x 34"D**STYLE:** Chair with swivel fully upholstered. Shell band fabric in Teatro in Guard, seat fabric in Article in Surf

NOFIJ-2

LOCATION: Teen Room

SHELL BAND UPHOLSTERY: Maharam Teatro in Guard
466309- 011 with Alta food and beverage backing/finish**SEAT UPHOLSTERY:** Maharam Article in Surf 458600- 046

AFTERCARE BENCH

KI - MyPlace Backless 45 Curve Lounge



DESCRIPTION

QUANTITY: 6

SIZE: 41.5”W x 28”D x 18”H

STYLE: 45 degree curve, non contrast upholstery,
concealed glide

MPC45/CGL/NC

LOCATION: Youth Center

UPHOLSTERY: Maharam, Apt in Nocturnal
466392-013

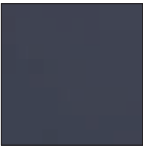

AFTERCARE LOUNGE
Bernhardt - Diego



DESCRIPTION

QUANTITY: 2

SIZE: 32.25"W x 32"D x 30.5"H x 16"SH

STYLE: Lounge chair with standard casters.
5682C

LOCATION: Youth Center

UPHOLSTERY: Designtex, Sorano in Persimmon
3403-703



CHILDRENS LOVESEAT

Naughtone - Hush Highback



DESCRIPTION

QUANTITY: 2

SIZE: 53”W x 32”D x 45.5”H x 17”SH

STYLE: Hush two seat sofa with oak legs and plastic glides

NOHUN22-3-PG

LOCATION: Children’s Library

UPHOLSTERY: Designtex, Big Dot in Cactus 3525-501

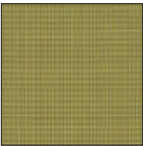

BASE: Solid Oak

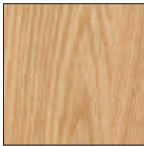

CHILDRENS OTTOMAN

Hightower - Nimbus Jr with Point



DESCRIPTION

QUANTITY: 6

SIZE: 24.5”W x 31”D x 18”H

STYLE: Nimbus Jr. with point, 2 of each color
HT11002

LOCATION: Children’s Library

(2) UPHOLSTERY: Momentum, Silica in Lemon
09143374

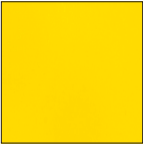

(2) UPHOLSTERY: Maharam, Apt in Chartreuse
466392-021



(2) UPHOLSTERY: Luum, Top Coat in Polish
4083-11

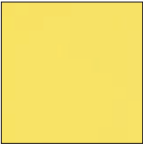

ADULT READER TABLE - SQUARE

Steelcase - Verlay



DESCRIPTION

QUANTITY: 5

SIZE: 42”D x 42”W x 28.5”H

STYLE: 42” square table, sitting height, wood legs. Square corners, with 3mm plastic edge, laminate top and walnut legs. One CC grommet.

VLYSQWL

LOCATION: Adult Collections

TOP: HPL, Steelcase in Clear Walnut 2538

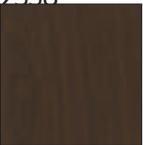

BASE: Steelcase Walnut Laquer 3325

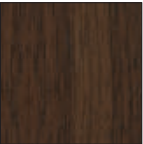

EDGE STYLE: 3 mm edge



BRACKETS/GROMMETS: Black



EDGEBAND: Steelcase Clear Walnut 6245

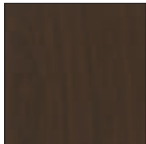

POWER: (1) CC Grommet without cover. 2 power, 2 USB-A



Wire management tray, size and quantity tbd. Black mesh cable manager with velcro attachment

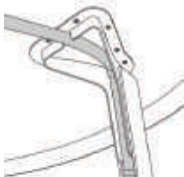
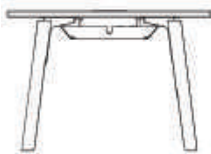

ADULT READER TABLE

Steelcase - Verlay



DESCRIPTION

QUANTITY: 5

SIZE: 42"D x 72"W x 28.5"H

STYLE: Rectangular table, sitting height, wood legs. Square corners, with 3mm plastic edge, laminate top and walnut legs. Two CC grommets and cable management tray and leg.

VLYRECWL

LOCATION: Adult Reading Room

TOP: HPL, Steelcase in Clear Walnut 2538



BASE: Steelcase Walnut Laquer 3325

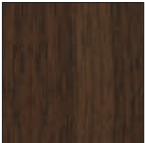

EDGE STYLE: 3 mm edge



BRACKETS/GROMMETS: Black

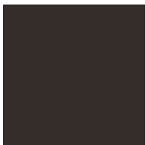

EDGE BAND: Steelcase Clear Walnut 6245



POWER: (2) CC Grommet without cover. 2 power, 2 USB-A



Wire management tray, size and quantity tbd. Black mesh cable manager with velcro attachment

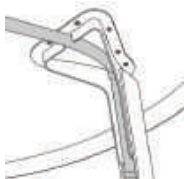
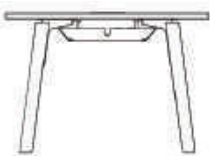

CONFERENCE TABLE

Steelcase - Verlay



DESCRIPTION

QUANTITY: 1

SIZE: 48"D x 144"W x 28.5"H

STYLE: Rectangular table, sitting height, with metal 2 split trestle leg. Square corners, with 3mm plastic edge, laminate top and walnut legs. Two CC grommets and cable management tray and leg.

VLYRECML

LOCATION: Conference Room

TOP: HPL, Steelcase in Clear Walnut 2538

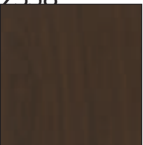

BASE: Steelcase Smooth Black 0835



EDGE STYLE: 3 mm edge



BRACKETS/GROMMETS: Black



EDGEBAND: Steelcase Clear Walnut 6245



POWER: (2) CC Grommet without cover. 2 power, 2 USB-A



Wire management tray, size and quantity tbd. Black mesh cable manager with velcro attachment

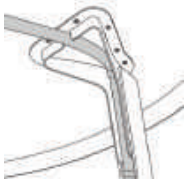
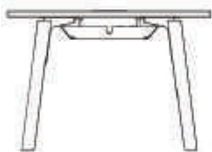

BREAKROOM TABLE

Steelcase - Verlay



DESCRIPTION

QUANTITY: 1

SIZE: 42"W x 84"D x 28.5"H

STYLE: Rectangular table, sitting height, wood legs. Square corners, with 3mm plastic edge, laminate top and walnut legs.

VLYRECWL

LOCATION: Staff Breakroom

TOP: HPL, Steelcase in Clear Walnut 2538

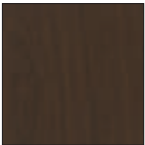

BASE: Steelcase Walnut Laquer 3325

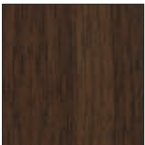

EDGE STYLE: 3 mm edge



BRACKETS/GROMMETS: Black

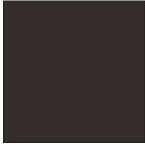

EDGEBAND: Steelcase Clear Walnut 6245

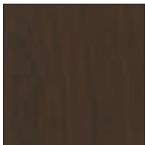

POWER: None

ROUND FOLDING TABLE

Southern Aluminum - IDesign Round Linenless Folding Table



DESCRIPTION	
QUANTITY:	15
SIZE:	60"Diameter x 29.75"H
STYLE:	Round folding table with A style leg D60RFVAL
LOCATION:	Senior Dining / Community Event Room

TOP: Wilsonart Pasadena Oak 7986



BASE: Silver

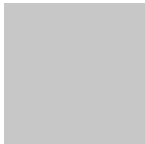

EDGE BAND: Silver



FLIP TOP TABLE - CHEVRON

Steelcase - Verb



DESCRIPTION

QUANTITY: 5

SIZE: 60"W X 30"D X 43"H (when table is flipped up)

STYLE: Chevron flip top table and steel modesty panel. Cast legs with four locking casters.

VTCF3060

LOCATION: Senior Dining / Community Event Room

TOP: HPL, Formica in Finnish Oak 118



UNDERSIDE: Dark



BASE: Steelcase Paint in Platinum Metallic 4799



BASE TYPE: Locked casters

EDGE BAND: Formica in Finnish Oak 118



MODESTY PANEL: Steelcase Paint in Platinum Metallic 4799



FLIP TOP TABLE - RECTANGULAR

Steelcase - Verb



DESCRIPTION

QUANTITY: 18

SIZE: 30"W x 60"D X 43"H (when table is flipped up)

STYLE: Rectangle flip top, cast legs with four locking casters.

VTR3060

LOCATION: (6) Flex Classroom
(12) Community Event Room

TOP: HPL, Formica in Finnish Oak 118



UNDERSIDE: Dark



BASE: Steelcase Paint in Platinum Metallic 4799



BASE TYPE: Locked casters

EDGE BAND: Formica in Finnish Oak 118



CHILDRENS FLIP TOP TABLE

KI - Trek Flip Top Table



DESCRIPTION

QUANTITY: 12

SIZE: 30"D X 60"W X 23-32"H

STYLE: Rectangular nesting flip top table at custom 25" height, with and flat vinyl edge and 4 casters.

T255FT-74P-ECO-LF/118-SX-4CB

LOCATION: Youth Center

TOP: Laminate, Formica Finnish Oak 118



BASE TYPE: 4 casters

BASE: Starlight Silver



EDGE BAND: Castle Oak

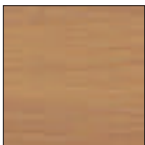

TEEN TABLE

Steelcase - Flex Standing Height



DESCRIPTION

QUANTITY:

2

SIZE:

70"W X 29"D X 41.375"H

STYLE:

Standing height mobile table with 2 glides and 2 wheels

FLXWTH

LOCATION:

Teen Room

TOP:

HPL, Formica in Finnish Oak 118



BASE:

Steelcase Paint in Low Gloss Black 4710



EDGEBAND:

Formica in Finnish Oak 118



TEEN PERSONAL TABLE

Coalesse - Lagunitas Personal Table



DESCRIPTION

QUANTITY: 2**SIZE:** 13"D X 24"W 25"H**STYLE:** Laminate table top and edgeband, with painted metal base and non adjustable glides

COLAGTP

LOCATION: Teen Room

TOP: HPL, Formica in Finnish Oak 118**BASE:** Paint Black Gloss 4144**EDGEBOARD:** Formica in Finnish Oak 118

TEEN COFFEE TABLE

Coalesse - Lagunitas Occasional Table



DESCRIPTION

QUANTITY: 1

SIZE: 18"D X 48"W X 16"H

STYLE: Occasional table with laminate table top and edge band, with painted metal base and non adjustable glides

COLAGTO

LOCATION: Teen Room

TOP: HPL, Formica in Finnish Oak 118



BASE: Paint Black Gloss 4144



EDGEBAND: Formica in Finnish Oak 118



OCCASIONAL SIDE TABLE
Herman Miller - Nelson Pedestal Table



DESCRIPTION

QUANTITY: 3

SIZE: 17”Dia X 21.5”H

STYLE: Round Table with walnut veneer top and edge band

5451W-BK-OU-OU

LOCATION: Senior Lounge

TOP: Wood Veneer Walnut OU

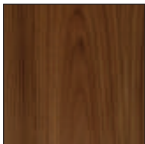

BASE: Black Paint



EDGE BAND: Wood Veneer
Walnut OU

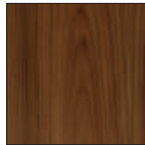

COFFEE TABLE

Herman Miller - Noguchi Rudder



DESCRIPTION	
QUANTITY:	3
SIZE:	50"W X 35.5"D X 15.75"H
STYLE:	Walnut table with hairpin chrome base. IN52-OU-47
LOCATION:	(1) Senior Lounge (2) Adult Collections

TOP: Wood Veneer Walnut OU

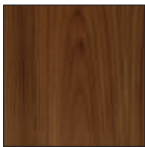

BASE: Trivalent Chrome 47



LAPTOP TABLE

Steelcase - Turnstone Campfire Personal Table



DESCRIPTION

QUANTITY: 4

SIZE: 19.5”D X 14”W X 26”H

STYLE: Personal table in Virginia Walnut Laminate
TS4TWP

LOCATION: First Floor Lobby

FINISH: Steelcase Natural Oak Veneer 3611



CHILDRENS TABLE - ROUND SMALL

Freshcoast - Quince Round 20" High



DESCRIPTION

QUANTITY: 2

SIZE: 36" Diam x 20"H

STYLE: 20" high round table in White Wash II with laminate top and PVC edge in white

QCT-20H-36D-8824-V2W-11

LOCATION: Children's Library

TOP: Formica White Drops 8824



BASE: Natural 11



EDGE BAND: White Vinyl

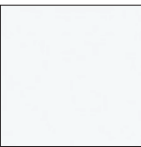

CHILDRENS TABLE - ROUND LARGE

Freshcoast - Quince Round 25" High



DESCRIPTION

QUANTITY: 2

SIZE: 36" Diam x 25"H

STYLE: 20" high round table in White Wash II with laminate top and PVC edge in white

QCT-25H-36D-8824-V2W-11

LOCATION: Children's Library

TOP: Formica White Drops 8824



BASE: Natural 11



EDGE BAND: White Vinyl

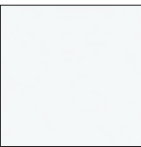

MAKERSPACE TABLE

3Branch - Maker Flex Butcher Block Adjustable Height



DESCRIPTION

QUANTITY: 6

SIZE: 72" W X 36"D X 29-47"H

STYLE: Height adjustable butcher block work surface with casters
MF-7236-ADJT-BBK-CAS

LOCATION: Makerspace

TOP: Solid maple butcher block



BASE: Platinum metallic



OUTDOOR BENCH

Country Casual - Bond 6' Backless



DESCRIPTION

QUANTITY:

6

SIZE:

22"D X 72"W 17.75"H

STYLE:

Backless bench with solid teak seat

6916

LOCATION:

(4) Front Entrance

(2) Playground

SEAT:

Solid Teak

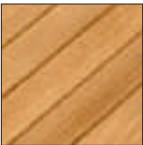

BASE:

Stainless Steel



OUTDOOR BENCH

Loll - Lollygagger Lounge Chair



DESCRIPTION

QUANTITY: 8

SIZE: 27"W X 29.5"D X 29.5"H

STYLE: LC-LL-DW

LOCATION: Pool Deck

COLOR: Driftwood



OUTDOOR CHAISE

Loll - Lollygagger Chaise



DESCRIPTION

QUANTITY: 6

SIZE: 74"W X 26"D X 29.75"H

STYLE: LC-LC-DW

LOCATION: Pool Deck

COLOR: Driftwood



OUTDOOR CHAISE - STACKING

Janus et Cie - Duo Stackable Mesh



DESCRIPTION

QUANTITY: 12

SIZE: 80"W X 26.75"D X 41.25"H X 13.5"SH

STYLE: Stackable chaise in graphite, with starlight mesh

719-58-211-81-86

LOCATION: Pool Deck

FRAME: Graphite



SEAT: Starlight mesh



OUTDOOR CHAIR

Design within Reach - Sustainable Lisboa Chair



DESCRIPTION

QUANTITY: 100

SIZE: 18.9”W X 20”D X 31.9”H

STYLE: Sustainable Lisboa arm chair in red

LOCATION: (42) Pool Deck
(38) East Terrace
(20) West Terrace

COLOR: Red



OUTDOOR TABLE

EMU - Round Series Square Table



DESCRIPTION

QUANTITY: 37

SIZE: 31.5"D X 31.5"W X 29.5"H

STYLE: CO2473

LOCATION: (15) Pool Deck
(15) East Terrace
(7) West Terrace

COLOR: EMU White 7271

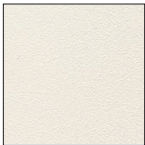

OUTDOOR UMBRELLA

Country Casual - Teak Umbrella 8 ft Octagon



DESCRIPTION

QUANTITY: 8

SIZE: 108”W X 108”D X 102”H

STYLE: 9 ft square umbrella with Oyster fabric. And with a 90 lb 27.5” square steel rolling base

Teak-7919
8312 (Base)

LOCATION: Pool Deck

COLOR: Oyster



CHILDRENS OUTDOOR LOUNGE

Plank - Land Lounge



DESCRIPTION

QUANTITY: 4

SIZE: 44"W X 32.6"D X 40.15"H X 15"SH

STYLE: 1100-00

LOCATION: Children's Library Terrace

COLOR: Basalt Grey



CHILDRENS OUTDOOR STONE

Concreteworks - Soma Stones



DESCRIPTION

QUANTITY: 6

SIZE: (3) X-small: 30”L X 25”W X 14”H
(3) Small: 42”L X 31”W X 13”H

STYLE: X-Small and Small stones, 3 of each, 1 of each color in each size

LOCATION: Children’s Library Terrace

COLOR: Chalk, (1) X-small, (1) Small



COLOR: Hurricane, (1) X-small, (1) Small



COLOR: Storm, (1) X-small, (1) Small

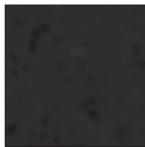

PICNIC TABLE

Extremis - Picnik



DESCRIPTION

QUANTITY: 5

SIZE: 37.5"W X 57.75"L X 29.5"H

STYLE: Picnik with floor fastening feet

LOCATION: (3) West Terrace
(2) Children's Library Terrace

COLOR: Sky blue RAL5024



MAKERSPACE OUTDOOR TABLE

Extremis - Hopper AA 300



DESCRIPTION	
QUANTITY:	4
SIZE:	64.17"W X 93.7"L X 29.13"H X 17.32" SH
STYLE:	Hopper AA 240 without shade and floor fastening AXTMHOPALUM240
LOCATION:	Makerspace Terrace

COLOR: Sky blue RAL5024



OUTDOOR SIDE TABLE

Loll - Lollygagger Side Table

DESCRIPTION

QUANTITY: 7

SIZE: 16" Diam X 14"H

STYLE: LC-LST-DW

LOCATION: Pool Deck



COLOR: Driftwood



CHILDREN'S ART

Magis - Fish

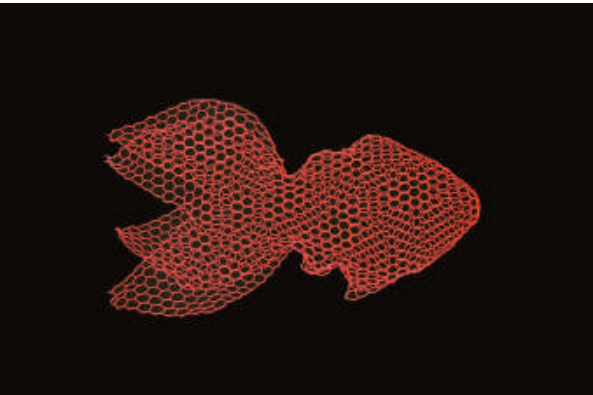

DESCRIPTION

QUANTITY: 1 Large
2 Medium
2 Small

SIZE: L: 31.5”L X 20.86”W X 18.9”H
M: 25.6”L X 17.23”W X 15.75”H
S: 19.7”L X 13.2”W X 11.8”H

STYLE: Metal mesh painted in epoxy resin, with hook for ceiling suspension.

LOCATION: Children's Library

MATERIAL: Matt color fluorescent red

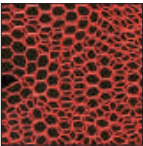

LOBBY TRASHCAN

Scandinavian Spaces - Kite Frame

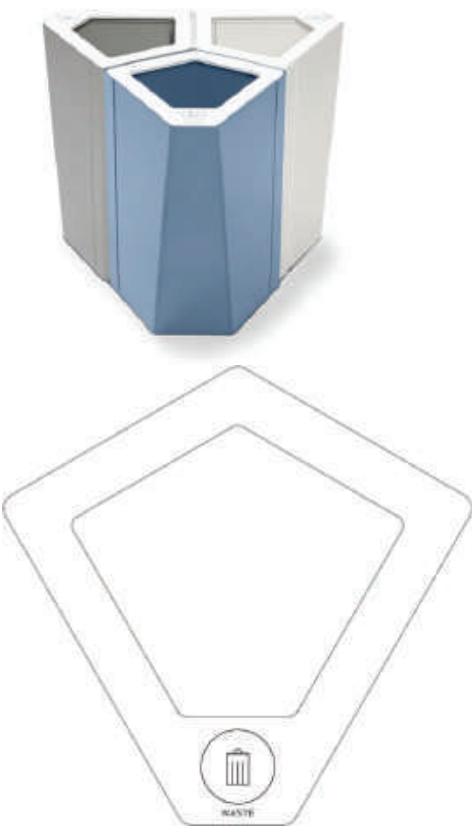

DESCRIPTION

QUANTITY: 3

SIZE: 19.7”W X 19.4”D X 27.6”H

STYLE: Kite frame standard Ral Colors, (1) Pearl White, (1) Brilliant Blue. Kite frame white/ grey in (1) Warm Grey.

With kite lids. (1) Kite lid waste, (1) Kite Lid Plastic (1) Kite Lid compost

LOCATION: (1) First floor Lobby (1) Makerspace
(1) Community Room (1) Adult collections
(1) Afterschool program
(1) 2nd Floor Lobby

FINISH: Pearl White



FINISH: Brilliant Blue



FINISH: Warm Grey

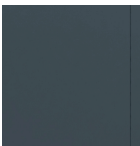

LID SYMBOL: Waste



LID SYMBOL: Plastic



LID SYMBOL: Organic



SENIOR LOUNGE ROOM SEPARATOR

Herman Miller - OE1 Agile Wall Full Shelves



DESCRIPTION

- QUANTITY:

(2) Frames
(2) Set of 4 shelves
- SIZE:

Frame: 36"W X 19"D X 75"H
Shelves: 36"W X 12"L X 7/8"D
- STYLE:

Full height shelves with glides. Frame in black. Shelves in medium walnut laminate

HZ120-75-36-1-BK (Frame)

HZ160-LBU-LBU (Shelves)
- LOCATION:

Senior Lounge

FRAME FINISH: Sand Texture Finish, Black



SHELF FINISH: Laminate, Medium Matte Walnut LBU



SHELF EDGEBAND: Laminate, Medium Matte Walnut LBU



SENIOR LOUNGE ROOM SEPARATOR

Herman Miller - OE1 Agile Wall Fully Cladded



DESCRIPTION

- QUANTITY:

(1) Frame with Glides
(1) Upper and Lower Tile
- SIZE:

Frame: 60"W X 19"D X 75"H
Panels: 60"W X 35"H X 3/8"D
Monitor mount: 23.6"W X 5/8"D x 17.25"H
- STYLE:

Full height, 60" wide frame in black. With tackable fabric panels. One side; lower panel with power, and monitor mount for upper panel. With user power.

HZ110-75-60-BK (Frame)
HZ130-35-60-R (Upper Panel)
HZ140-35-60-RP (Lower Panel)
HZ170-1-P-T-OH (Monitor Mount)
- LOCATION:

Senior Lounge

FRAME FINISH: Sand Texture Finish, Black



PANEL FINISH: Herman Miller, Aristo in Green Apple 3AR08



MONITOR MOUNT: Black

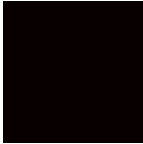

LECTERN

Coalesse - Exponents Lectern



DESCRIPTION

QUANTITY:

1

SIZE:

23.5"W X 18.75"D X 48"H

STYLE:

Lectern in flat cut low sheen wood veneer. Integrated power; 2 power receptacles, 3 data and 1 VGA. Power in black.

COCL42-PVD

LOCATION:

Senior Dining / Community Event Room

FINISH:

Coalesse, Rift cut, Natural Oak Low Sheen V3AK

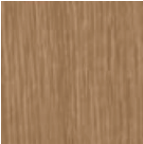

STACKING CHAIR CART
Herman Miller - Pronto Cart



DESCRIPTION

QUANTITY: 4

SIZE: 27.25"W X 81"D X 38.38"H

STYLE: Dolley for Pronto Stacking chairs. Stacks 36 chairs per cart. Black with 4" soft wheel casters

JOC-GHC

LOCATION: Furniture Storage

FINISH: Black



ROUND FOLDING TABLES CART

Southern Aluminum - GHD Table Trucks



DESCRIPTION	
QUANTITY:	3
SIZE:	33"W X 72.5"D
STYLE:	Table trucks for Idesign folding round tables. 5 tables per cart. TT606672RGHD
LOCATION:	Furniture Storage

FINISH: Black



POWER TOWER

KI - Isle Power Tower



DESCRIPTION

QUANTITY: 3

SIZE: 25.5”H X 18”Diameter

STYLE: Power tower in silver
ISLE.SX

LOCATION: (1) Senior Lounge
(1) Adult Collections
(1) Teen Room

FINISH: KI Starlight Silver



MOBILE BOOK SHELVING

Estey - Mobile Shelving



DESCRIPTION

QUANTITY: 22

SIZE: 36”W X 42”H (plus caster height)

STYLE: Shelving to match image. Estey concealed caster double faced shelving system (22 units total). Each shelving unit to be 36” wide x 42” high (plus caster height) with three 12” deep (11” actual depth) shelf openings each section face. Each range to be equipped with laminate end panels and canopy tops with 3 mm PVC edge banding all exposed edges. End panels with slats and signage.

LOCATION: (10) Children’s Library
(12) Adult Collections

SHELF FINISH: White

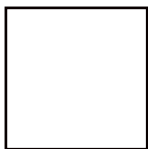

END AND TOP PANELS: HPL Formica Finnish
Oak 188



SMALL WIRE SHELVING

Global Industrial - 5-Tier Nexel ESD Wire Shelving



DESCRIPTION

QUANTITY: 3

SIZE: 24"W X 74"H X 14"D

STYLE: Wire shelving with 5 adjustable shelves
T9FB2351667

LOCATION: Janitor Closets

FINISH: Chrome



MEDIUM WIRE SHELVING

Global Industrial - 5-Tier Nexel ESD Wire Shelving



DESCRIPTION	
QUANTITY:	5
SIZE:	48"W X 74"H X 18"D
STYLE:	Wire shelving with 5 adjustable shelves T9FB2333380
LOCATION:	(2) YC Storage Rm 117 (1) Book sorter Rm 119 (2) Storage Rm 213 & 214 (1) Private Office Storage Rm 226A

FINISH: Chrome



LARGE WIRE SHELVING

Global Industrial - 5-Tier Nexel ESD Wire Shelving



DESCRIPTION

QUANTITY: 44

SIZE: 48"W X 74"H X 24"D

STYLE: Wire shelving with 6 adjustable shelves
T9FB2333307

LOCATION: First floor: (15) Pool Storage
(14) Gym Storage
(5) YC Storage 114
(1) YC Storage Rm 117
(1) Senior Staff Storage Rm 135
Second floor: (4) Movement Studio Storage Rm 206
(1) Fitness Storage Rm 209
(5) MC storage Rm 216
(1) Private office storage Rm 226

FINISH: Chrome



FITNESS STORAGE

Amazon - Gym Equipment Storage Rack Resistance Bands Hanger



DESCRIPTION

QUANTITY: 2

SIZE: 23"W X 5"H X 3"D

STYLE: Resistance band hanger, 11 prongs
B08W343D23

LOCATION: Movement Studio Storage

FITNESS STORAGE

Global Industrial - Power Systems Premium Dumbbell Storage Rack



DESCRIPTION

QUANTITY: 1

SIZE: 43"W X 42"H X 28"D

STYLE: Dumbbell hand weight rack with 44 Vinyl Dumbbell Pairs
T9FB2253082

LOCATION: Fitness room storage closet

Herman Miller - Canvas

Drawings not to scale

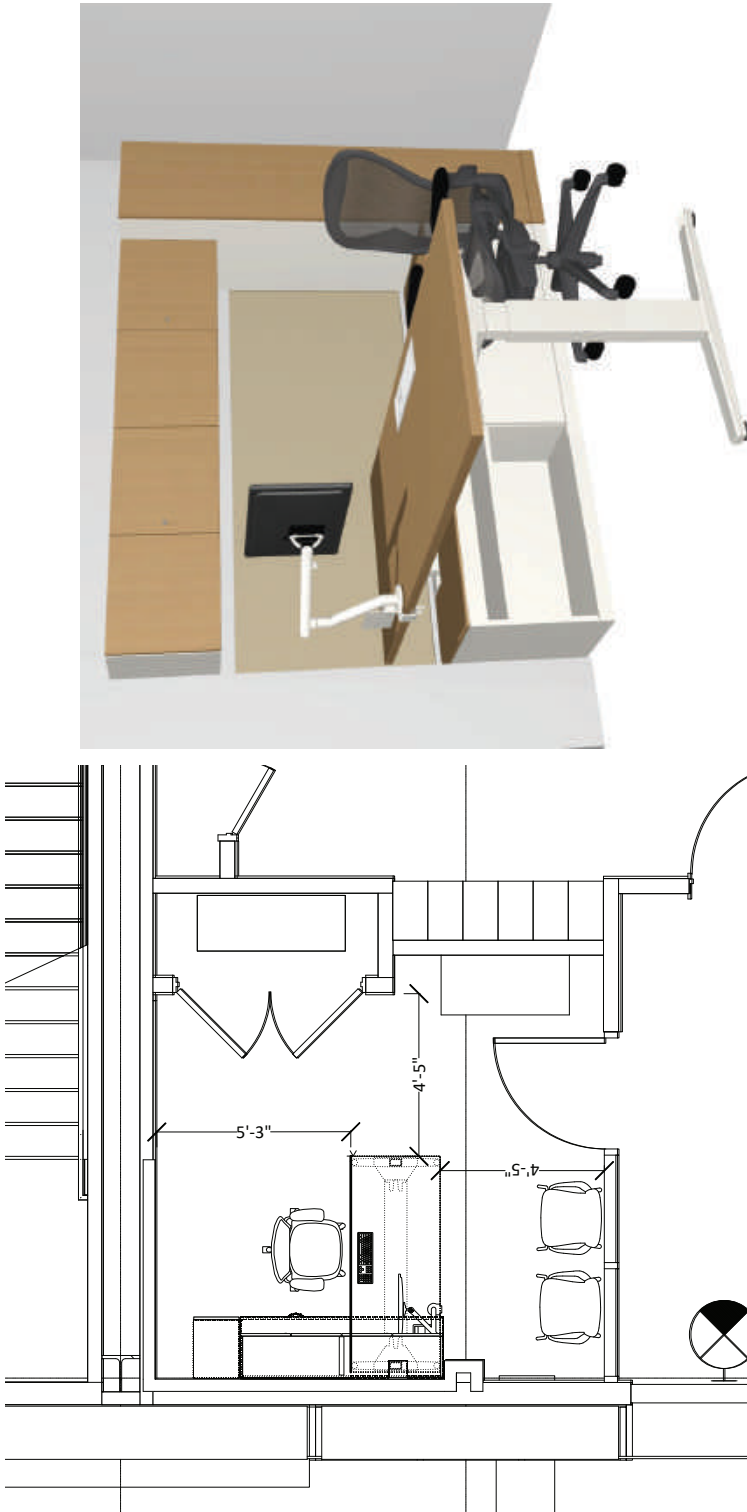

PRIVATE OFFICE TYPICAL -02
FLOOR -02

Print Date: 6/23/2022

Scale: 3/8" = 1'-0"

Dwg: Robert Colson

Project Number: 408736

Client: Menlo Park Library

Project Info: New Library

Address: 800 Alma Street, Main Library

City: Menlo Park, CA

Zip:

Sheet Title: Furniture Plan

Sheet No.: 1 of 1

INITIALS	REVISION	DATE
△	XX	.
△	XX	.
△	XX	.
△	XX	.

PROGRESS

Robert

Pivot Project Inc.
1000 Lakeside Dr., Suite 100
Folsom, CA 95630
415.581.8800

Drawings not to scale

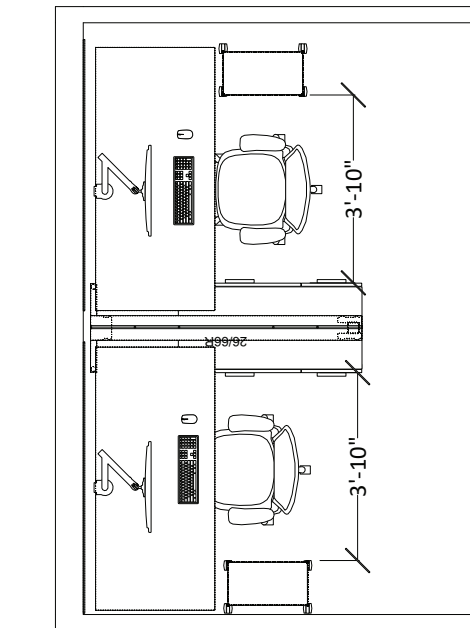

WORKSTATION TYPICAL

Print Date:	6/23/2022
Scale:	1/2" = 1'-0"
Dwg.	Robert Colson
Project Number:	408736
Client:	Menlo Park Library
Project Info:	New Library
Address:	800 Alma Street, Main Library
City:	Menlo Park, CA
Zip	
Sheet Title:	Furniture Plan
Sheet No. :	1 of 1

ADULT COLLECTION'S CIRCULATION DESK

Creative Wood or Equal - Custom
Drawings not to scale

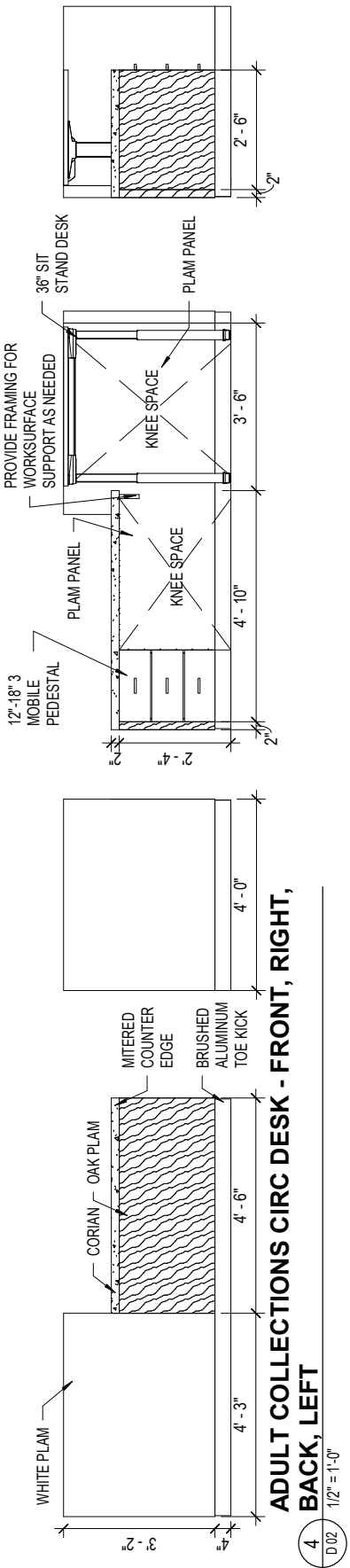
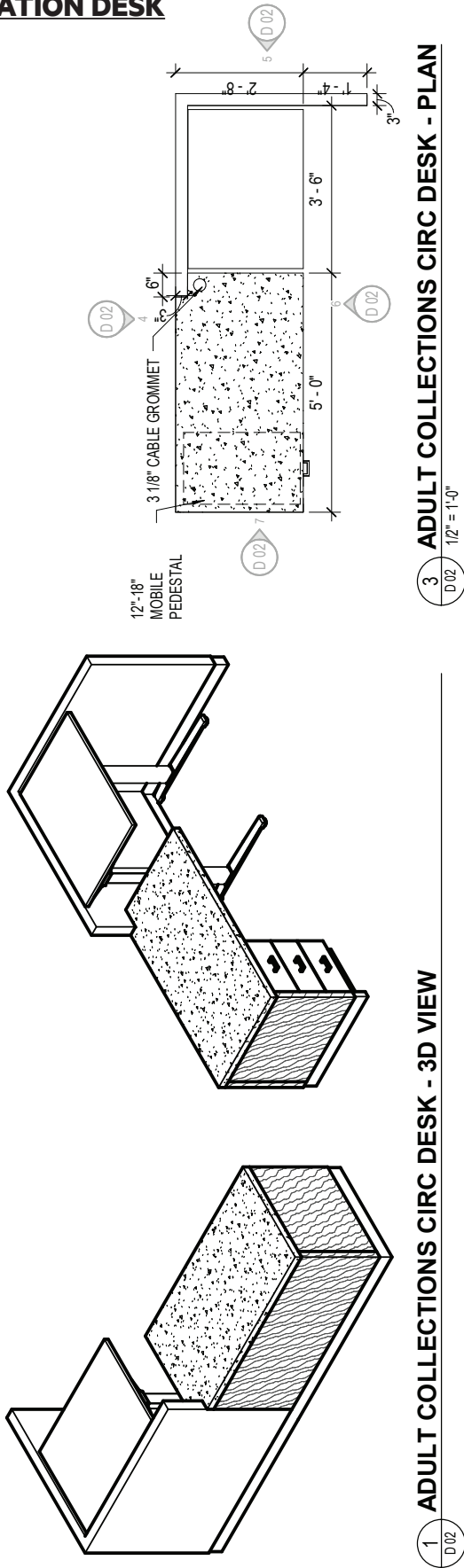

ADULT COLLECTION'S SELF CHECK DESK

Creative Wood or Equal - Custom

Drawings not to scale

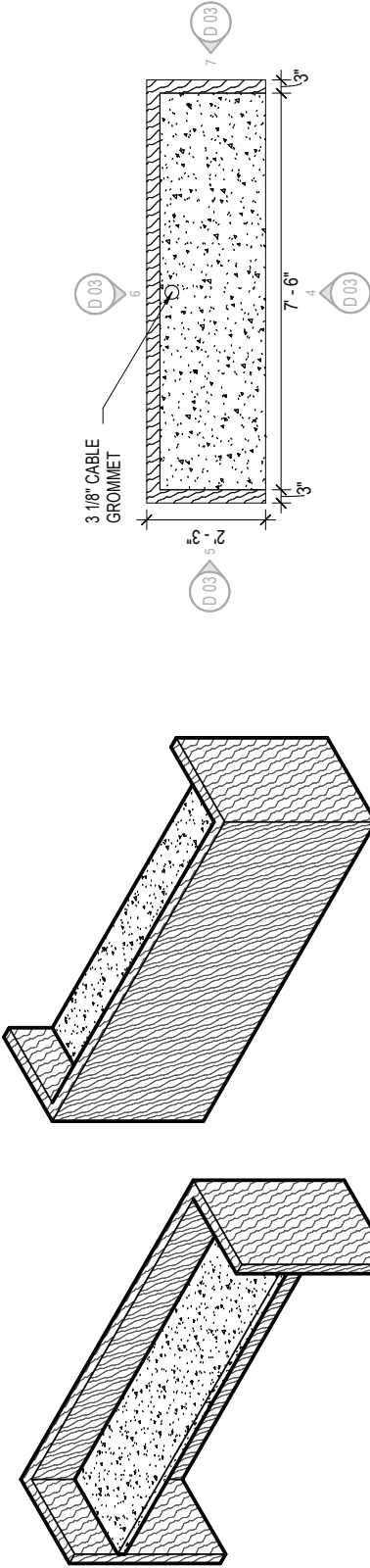

1 ADULT COLLECTIONS SELF CHECK DESK - 3D VIEW

3 ADULT COLLECTIONS SELF CHECK DESK - PLAN

1/2" = 1'-0"

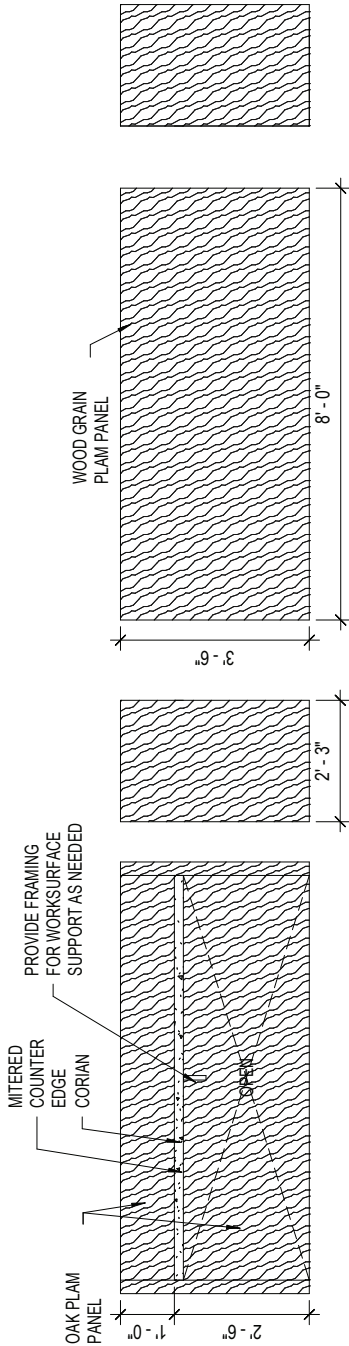

ADULT COLLECTIONS SELF CHECK - FRONT, LEFT,

BACK, RIGHT

1/2" = 1'-0"

CHILDREN’S LIBRARY CIRCULATION DESK

Creative Wood or Equal - Custom

Drawings not to scale

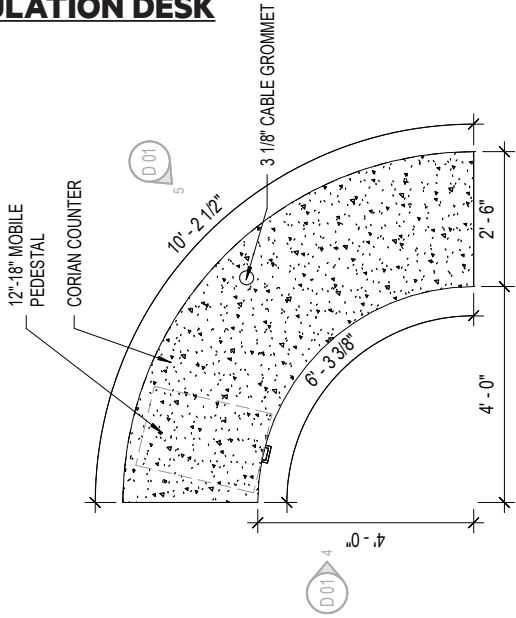

3 CHILDRENS CIRC DESK - PLAN
1/2" = 1'-0"

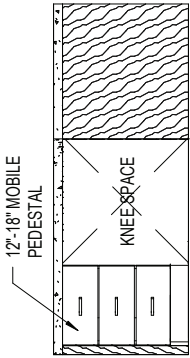

6 CHILDRENS CIRC DESK - BACK
1/2" = 1'-0"

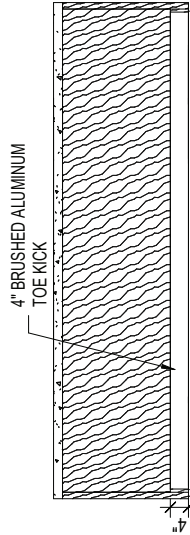
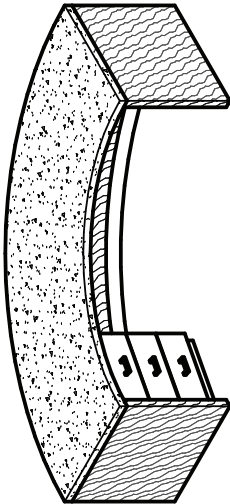

5 CHILDRENS CIRC DESK - FRONT
1/2" = 1'-0"

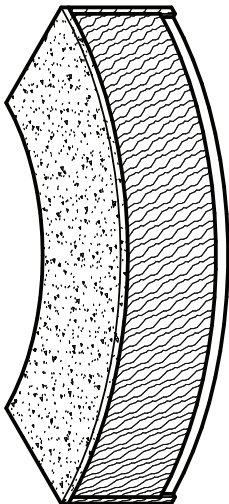

1 CHILDRENS CIRC DESK - 3D VIEW
D01

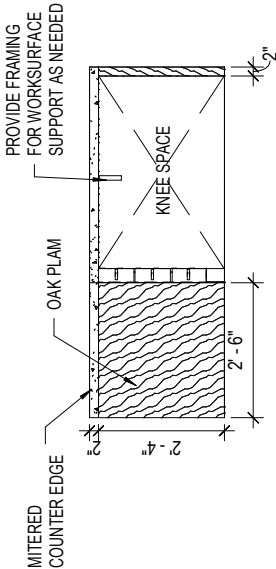

4 CHILDRENS CIRC DESK - SIDE
1/2" = 1'-0"

BOOK DROP

Bibliotheca - Flex Book Drop

Flat Front

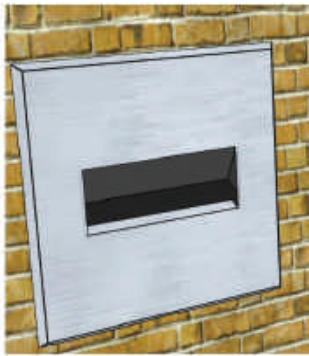

DESCRIPTION

QUANTITY: 1

SIZE:

STYLE: Flat front RFID Enabled
AMH51003-00

Library Equipment may not be included in final furniture package. TBD

LOCATION: Book Sorter Room

AUTOMATIC BOOK SORTER

Bibliotheca - AMH

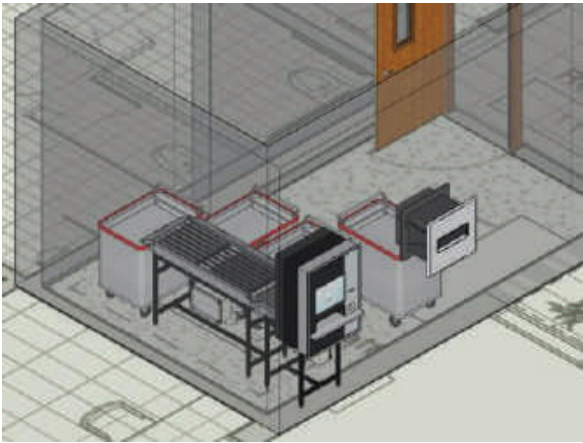

DESCRIPTION

QUANTITY: 1

SIZE:

STYLE: 3 bins 1 sided external induction

Library Equipment may not be included in final furniture package. TBD

LOCATION: Book sorter room

SELF CHECK

Bibliotheca - Self Check 1000

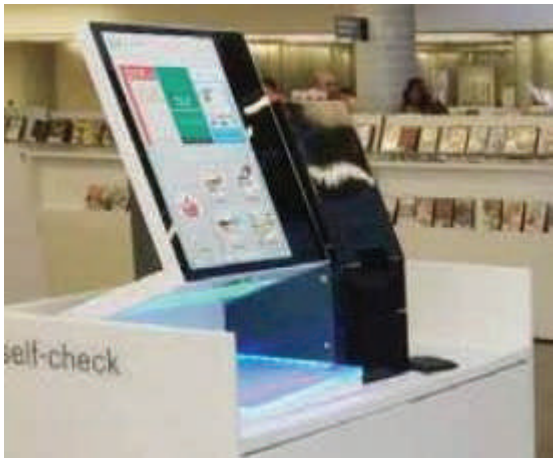

DESCRIPTION

QUANTITY: 3

SIZE: 24"W X 21.7"D X 29.9"H

STYLE: Desktop

AMH51003-00

Library Equipment may not be included in final furniture package. TBD

LOCATION: (1) Children’s Library
(2) Adult Collections

FINISH: Black



RFID WORKSTATION

Bibliotheca - RFID Workstation



DESCRIPTION

QUANTITY: 3

SIZE: 13.8"W X 11"D X 0.6"H

STYLE: Long description
AMH51003-00

Library Equipment may not be included in
final furniture package. TBD

LOCATION: (1) First floor reception desk
(1) Children's Library
(1) Adult Collections

RFID WORKSTATION BARCODE SCANNER

Global Industrial - Datalogic 1D/2D Cordless Barcode Scanner



DESCRIPTION

QUANTITY: 3

SIZE:

STYLE: GBT4500-WH-WLC

Library Equipment may not be included in final furniture package. TBD

LOCATION: (1) First floor reception desk
(1) Children’s Library
(1) Adult Collections

FINNISH: White

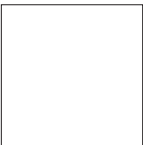

RFID GATE

Bibliotheca - Floor mounted RFID gate



DESCRIPTION

QUANTITY: 1

SIZE: 27.6”W X 2.9”D X 70”H

63” spacing between gates

STYLE: Direct floor mounted with wiring through floor mounted threshold wireway

LOCATION: Adult Collections

BASE: Brushed aluminum

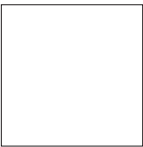

Library Equipment may not be included in final furniture package. TBD

LEG EXTENSION / CURL

True Fitness - SD-100 Leg Extension / Leg Curl



DESCRIPTION

QUANTITY: 1

SIZE: 57.5"W X 47.5"D X 57"H

STYLE: Leg extension / leg curl machine with charcoal powder coat finish and black vinyl seat

LOCATION: Fitness

FRAME: Charcoal



SEAT: Black



SMITH MACHINE

True Fitness - Smith Machine



DESCRIPTION

QUANTITY: 2

SIZE: 87"W X 48"D X 87"H

STYLE: Weights not included
XFW-6800

LOCATION: Fitness

FRAME: Charcoal



LEG PRESS

True Fitness - Leg press



DESCRIPTION

QUANTITY: 1

SIZE: 71”W X 97”D X 56”H

STYLE: Long description
XFW-7800

LOCATION: Fitness

FRAME: Charcoal



SEAT: Black



UPRIGHT BIKE

True Fitness - TRUE CS400 Upright Bike



DESCRIPTION

QUANTITY: 1

SIZE: 44"W X 24"D X 59"H

STYLE: Upright bike in charcoal with Emerge II LED Console

TRUE CS400

LOCATION: Fitness

FRAME: Charcoal



SEAT: Black



ELLIPTICAL

True Fitness - TRUE Performance 300 Elliptical



DESCRIPTION

QUANTITY: 1

SIZE: 70"W X 32"D X 64"H

STYLE: Elliptical with Emerge II LED Console
PS300

LOCATION: Fitness

FRAME: Grey



TREADMILL

True Fitness - TRU CS900 Commercial Treadmill



DESCRIPTION

QUANTITY: 3

SIZE: 84"W X 34.5"D X 60.5"H

STYLE: Treadmill with Emerge II LED Console
C900

LOCATION: Fitness

STAIRMASTER

StairMaster - Gauntlet 10G Stepmill



DESCRIPTION

QUANTITY: 1

SIZE: 34"W X 66"D X 83"H

STYLE: Stairmaster with 10" LCD

LOCATION: Fitness

BASE: Black

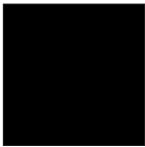

DUAL STACK FUNCTIONAL TRAINER

TuffStuff - Dual stack functional trainer



DESCRIPTION

QUANTITY: 1

SIZE: 118”W X 63”D X 83”H

STYLE: MFT-2700

LOCATION: Fitness

BASE: Silver



STRETCH CAGE

True Fitness - TRUE Stretch



DESCRIPTION

QUANTITY: 1

SIZE: 60"W X 48"D X 87"H

STYLE:

LOCATION: Fitness

BASE: Silver

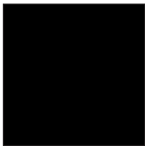

ADJUSTABLE BENCH

True Fitness - Hammer strength multi-adjustable bench



DESCRIPTION

QUANTITY: 6

SIZE: 54"W X 27"D X 18"H

STYLE: Hammer Strength Multi Adjustable Bench back pad with six adjustable pressing angles, and seat pad has four adjustments

LOCATION: Fitness

SEAT: Black

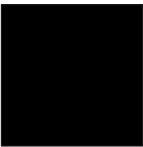

BASE: Silver



FITNESS TREE

Hoist - HF-5692 Fitness Tree



DESCRIPTION

QUANTITY: 1

SIZE: 44"W X 44.25"D X 83.25"H

STYLE: HF-5962

LOCATION: Fitness

SEAT: Grey



BASE: Silver



DUMBBELL RACK

Hoist - 12 pair saddle beauty bell dumbbell rack



DESCRIPTION

QUANTITY: 2

SIZE: 55"W X 26"D 37.5"H

STYLE: 3 tier horizontal rack
CF-3462-3

LOCATION: Fitness

BASE: Silver



SECOND FLOOR

- CHAIR
- TABLE
- LOUNGE
- OUTDOOR
- ACCESSORIES
- STORAGE
- WORKSTATIONS
- EQUIPMENT

